

TORX IS A REGISTERED TRADEMARK OF ACUMENT® INTELLECTUAL PROPERTIES, LLC

REVISION HISTORY			
REV	DATE	BY	DESCRIPTION
C	30DEC2024	PSP/SAK	PRN: P2025-0038

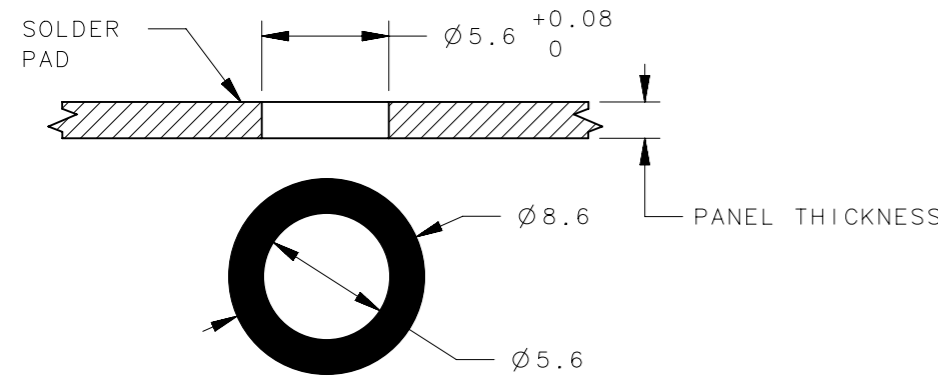

PANEL PREPARATION

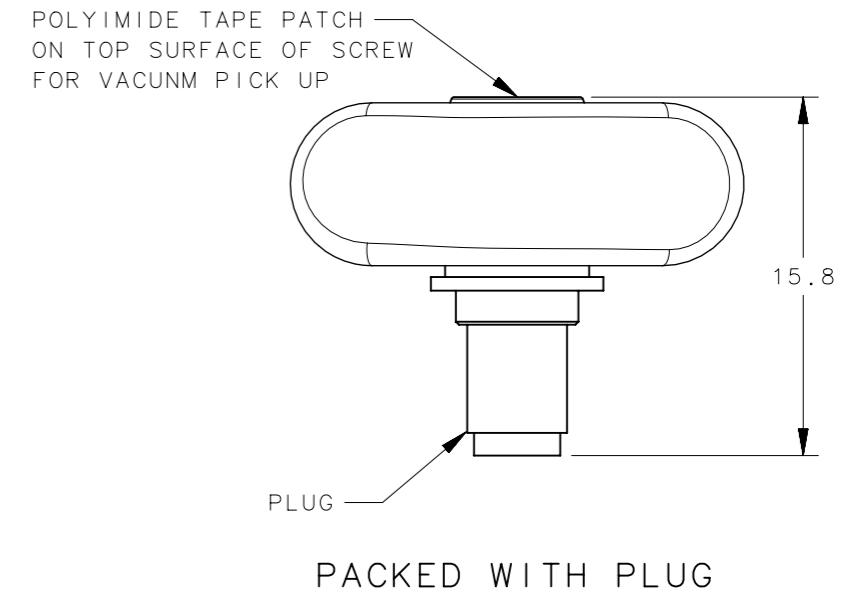
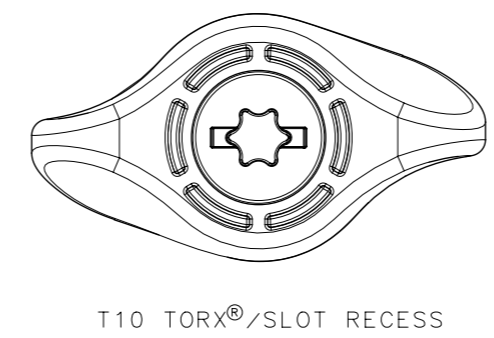
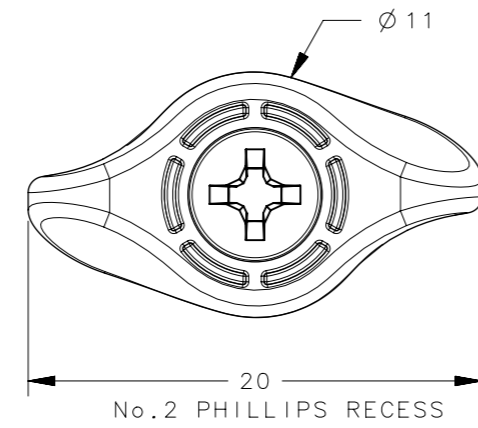
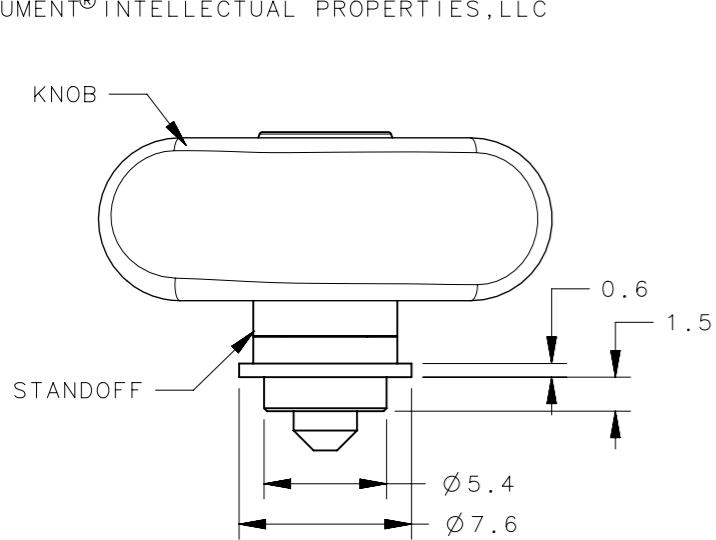
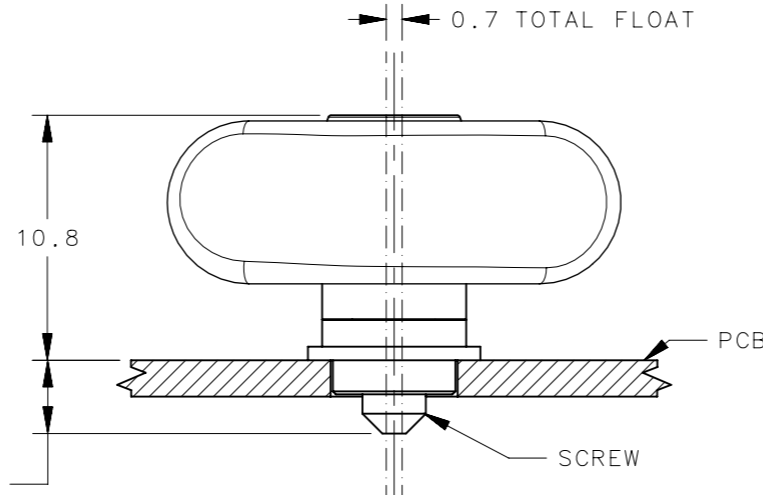

UNFASTENED

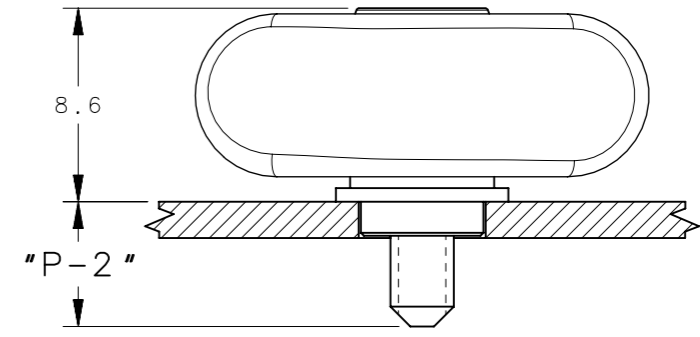

FASTENED

- NOTES:
- A. MATERIAL AND FINISH: RoHS COMPLIANT
 SCREW: STEEL, HARDENED, ZINC PLATE PLUS SEALER
 SPRING: STAINLESS STEEL, PASSIVATED
 STANDOFF: STEEL, TIN PLATE
 KNOB: PA9T GP2450NH, UL94-V0 RATED, FLAME RETARDANT
 PLUG: SILICONE RUBBER
 PATCH: POLYIMIDE
 - B. INSTALLATION INSTRUCTION:
 1. PREPARE HOLE AND SOLDER PAD AS SHOWN. HOLE DIAMETER, INCLUDING TOLERANCE, IS FINAL SIZE.
 2. PRINT THE PCB BOARD WITH SOLDER PASTE. THE SOLDER PASTE SHOULD COVER THE SOLDER PAD.
 3. SMT MACHINE TO PICK AND PLACE THE WHOLE SCREW WITH PATCH AND PLUG INTO LOCATED PANEL HOLES.
 4. THE PC BOARDS WILL CONTINUE THROUGH THE SET UP HEAT SOLDERING CHAMBER AND FINISH THE CYCLE. MAXIMUM TEMP 535°F (280°C). NITROGEN ATMOSPHERE RECOMMENDED TO DIMINISH DISCOLORATION.
 5. THE PATCH AND PLUG ON SCREW WILL BE REMOVED AFTER SOLDERING DONE AND CANNOT BE REUSED.
 6. TO REMOVE THE PLUG: PULL SCREW HEAD UP TO UNFASTENED POSITION, THEN THE PLUG CAN BE PULLED OFF EASILY.
 - C. COSMETIC SPECIFICATION: ALL SURFACES (UNLESS OTHERWISE SPECIFIED) ARE TO BE PER SOUTHCO SPECIFICATION S-121-02 AND S-121-04, CLASS B, STANDOFF CLASS C (REFER TO SECTION 1.0 FOR CROSS REFERENCE TABLE).
 - D. SEE PAGE 2 AND 3 FOR PACKAGE INFORMATION.

PART NUMBER 4C-SM-1121-WEEE SHOWN

- *B* RECESS TYPE
 1 - No.2 PHILLIPS
 4 - T10 TORX®/SLOT
- *EEE* KNOB COLOR
 000 - BLACK
 SEE J-47-0-3 FOR ADDITIONAL COLORS
- *P* PACKAGE
 BLANK - SCREW ASSEMBLY, BULK
 R - REEL PACKAGE



SCALE 1:1

4C-SM-1B21-WEEE-P	3.3	5.5	1.6
4C-SM-1B11-WEEE-P	1.5	3.8	
PART NUMBER	*P-1*	*P-2*	PANEL THICKNESS
THIRD ANGLE PROJECTION			
MILLIMETERS [IN]			
TOLERANCES UNLESS OTHERWISE NOTED		DESCRIPTION	
ALL DIMENSIONS WITHOUT TOLERANCES ARE FOR REFERENCE ONLY.		4C-SM WING HEAD CAPTIVE FASTENER 4-40 THREAD, SMT STYLE	
PROPRIETARY ITEM	PER ASME Y14.5M-2009	SIZE A3	SYSTEM NX
EXCEPT FOR USES EXPRESSLY GRANTED IN WRITING, INFORMATION DISCLOSED HEREON IS CONFIDENTIAL AND ALL RIGHTS, PATENT AND OTHERWISE, ARE RESERVED BY SOUTHCO, INC.		DWG NO. J-4C-SM-440-W	DATE 09APR2015
		DRAWN BY ER	SCALE 3:1
		SHEET 1 OF 2	

REVISION HISTORY			
REV	DATE	BY	DESCRIPTION
C	30DEC2024	PSP/SAK	PRN: P2025-0038

USER DIRECTION

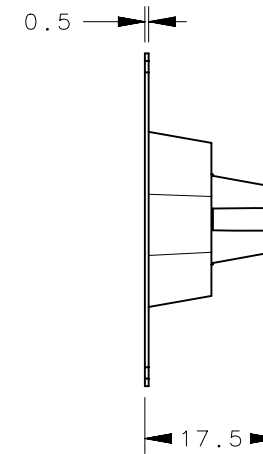
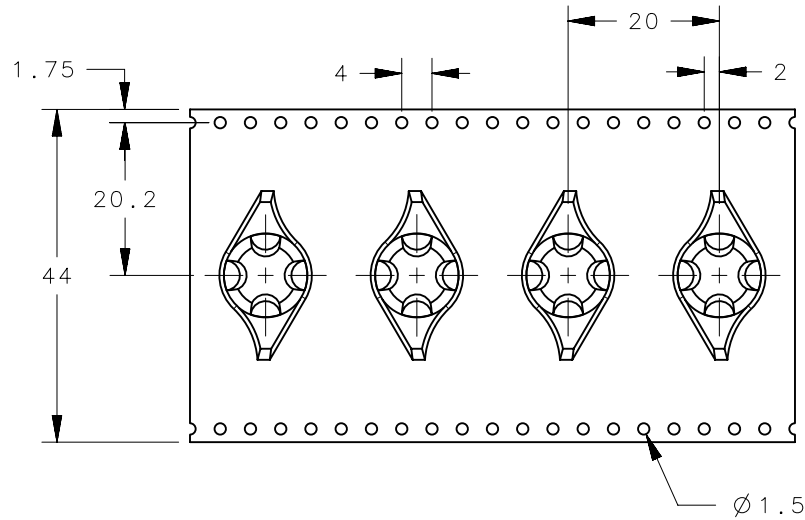

REEL PACKAGE: 13 INCH REEL PER EIA-481, 150 PIECES PER REEL
 MATERIAL: POLYSTYRENE, BLACK

	THIRD ANGLE PROJECTION	 CONNECT • CREATE • INNOVATE		
	MILLIMETERS [IN]			
	TOLERANCES UNLESS OTHERWISE NOTED	DESCRIPTION 4C-SM WING HEAD CAPTIVE FASTENER 4-40 THREAD, SMT STYLE		
	ALL DIMENSIONS WITHOUT TOLERANCES ARE FOR REFERENCE ONLY.	SIZE A4	SYSTEM NX	DWG NO. J-4C-SM-440-W
PROPRIETARY ITEM <small>EXCEPT FOR USES EXPRESSLY GRANTED IN WRITING, INFORMATION DISCLOSED HEREON IS CONFIDENTIAL AND ALL RIGHTS, PATENT AND OTHERWISE, ARE RESERVED BY SOUTHCO, INC.</small>	PER ASME Y14.5M-2009	DRAWN BY ER	DATE 09APR2015	SCALE 1:1 SHEET 2 OF 2