

6

5

4

3

2

1

REVISION HISTORY			
REV	DATE	BY	DESCRIPTION
A	22OCT2024	APA/VK	PRN: P2024-1785

R4-10-S I -30 B - M

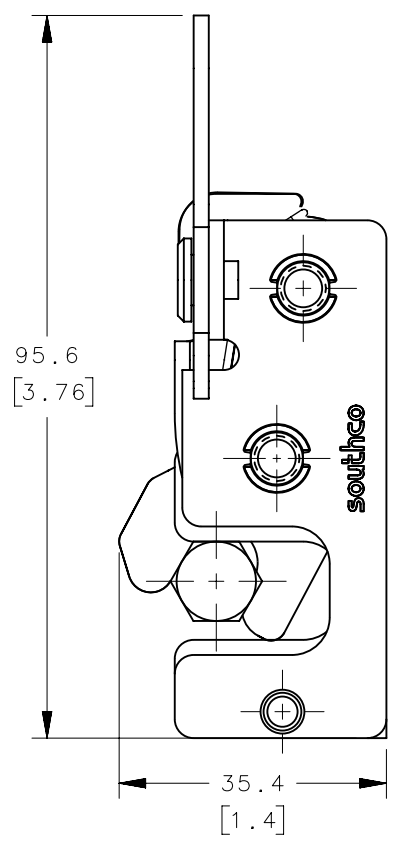

SECONDARY STAGE  
FOR TWO STAGE  
LATCHES ONLY

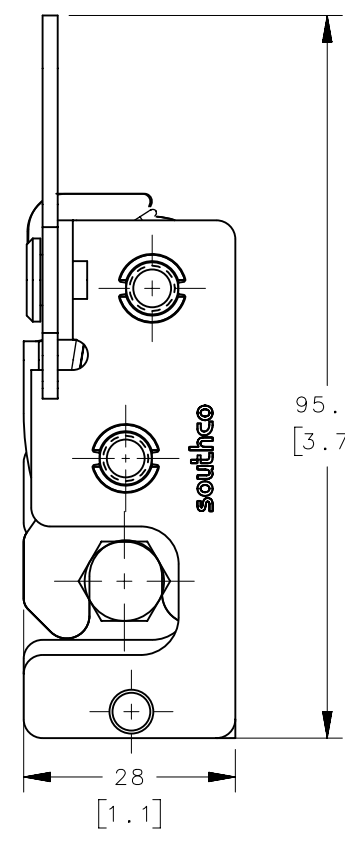

PRIMARY STAGE  
FOR SINGLE AND  
TWO STAGE LATCHES

**S** STAGE & ACTUATION

- 1 SINGLE STAGE, RIGHT HAND
- 2 SINGLE STAGE, LEFT HAND
- 3 TWO STAGE, RIGHT HAND
- 4 TWO STAGE, LEFT HAND

**I** MOUNTING STYLE

- 0 Ø7.2 [.283] THRU
- 1 1/4-20 THREAD
- 2 M6 X 1 THREAD

**M** MATERIAL

- 10 STEEL, ZINC PLATED
- 15 STEEL, BLACK ZINC NICKEL PLATED
- 20 STAINLESS STEEL, PASSIVATED
- 77 STEEL, ZINC NICKEL PLATED

**B** BASE STYLE

- 1 STANDARD
- 5 INTEGRATED BUMPER

RIGHT HAND,  
STANDARD

LEFT HAND,  
STANDARD

RIGHT HAND,  
INTEGRATED BUMPER

LEFT HAND,  
INTEGRATED BUMPER

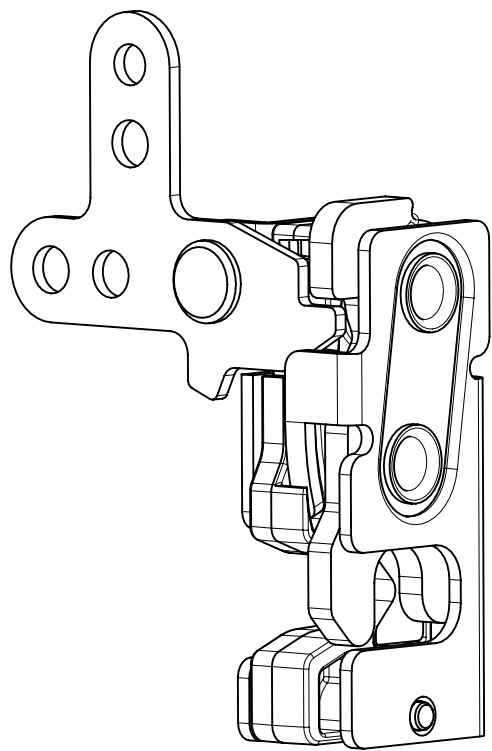
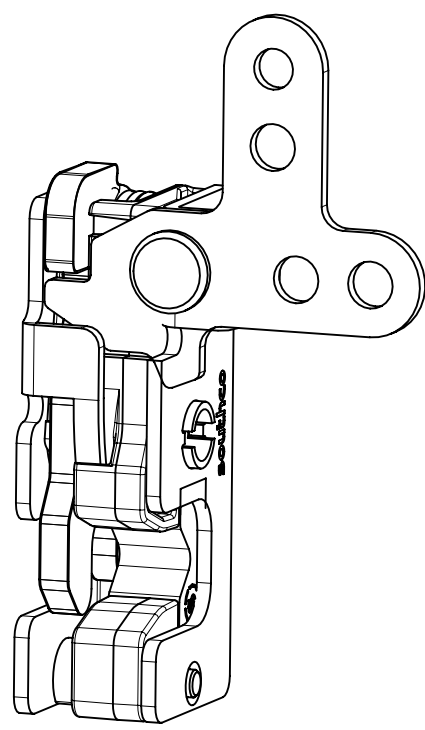
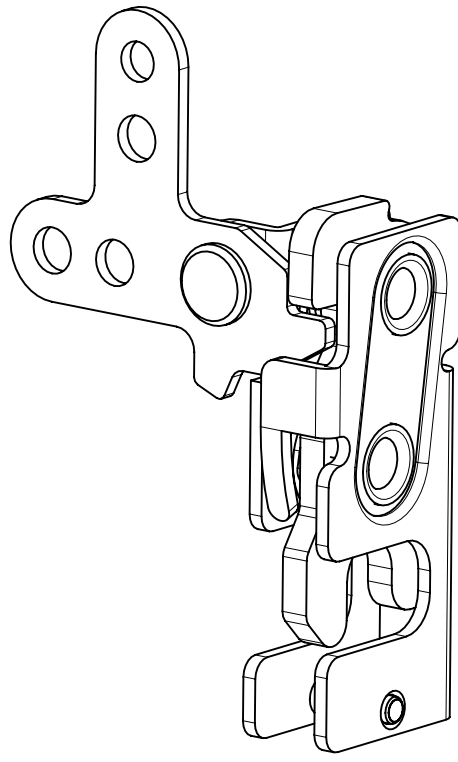
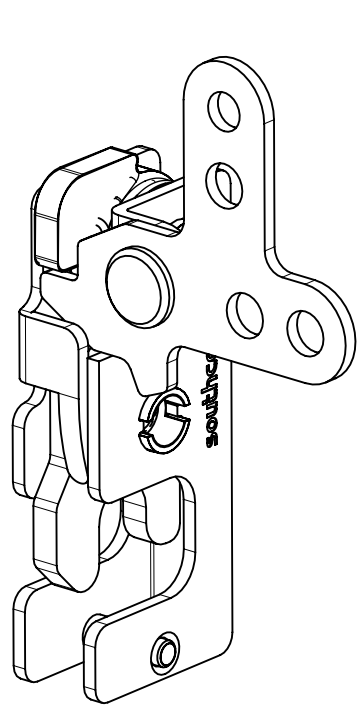

NOTES:

- A. MATERIAL AND FINISH:
- HOUSING, LEVER, PAWL, TRIGGER AND PINS: MATERIAL - STEEL
  - 10 ZINC PLATED, BRIGHT CHROMATE
  - 77 ZINC NICKEL, BRIGHT CHROMATE
  - 15 ZINC NICKEL, BLACK
  - MATERIAL - STAINLESS STEEL
  - 20 PASSIVATED
  - SPRING: STAINLESS STEEL, PASSIVATED

- B. INTEGRATED BUMPER MATERIAL:
- GUIDE - DELRIN, BLACK
  - STOP BLOCK - EPDM, DURO 60, SHORE A

PROPRIETARY ITEM EXCEPT FOR USES EXPRESSLY GRANTED IN WRITING, INFORMATION DISCLOSED HEREON IS CONFIDENTIAL AND ALL RIGHTS, PATENT AND OTHERWISE, ARE RESERVED BY SOUTHCO, INC.	THIRD ANGLE PROJECTION	 CONNECT · CREATE · INNOVATE																	
	MILLIMETERS [IN]		DESCRIPTION																
	TOLERANCES UNLESS OTHERWISE NOTED	ALL DIMENSIONS WITHOUT TOLERANCES ARE FOR REFERENCE ONLY.	R4 ROTARY LATCH TWO-POINT TRIGGER																
	PER ASME Y14.5M-2009	<table border="1" style="font-size: x-small;"> <tr> <td>SIZE</td> <td>SYSTEM</td> <td>DWG NO.</td> </tr> <tr> <td>B</td> <td>NX</td> <td>J-R4-10-301</td> </tr> <tr> <td>DRAWN BY</td> <td>DATE</td> <td>SCALE</td> </tr> <tr> <td>APA/VK</td> <td>18OCT2024</td> <td>1:1</td> </tr> <tr> <td colspan="2"></td> <td>SHEET</td> </tr> <tr> <td colspan="2"></td> <td>1 OF 4</td> </tr> </table>	SIZE	SYSTEM	DWG NO.	B	NX	J-R4-10-301	DRAWN BY	DATE	SCALE	APA/VK	18OCT2024	1:1			SHEET		
SIZE	SYSTEM	DWG NO.																	
B	NX	J-R4-10-301																	
DRAWN BY	DATE	SCALE																	
APA/VK	18OCT2024	1:1																	
		SHEET																	
		1 OF 4																	

6

5

4

3

2

1

6

5

4

3

2

1

REVISION HISTORY			
REV	DATE	BY	DESCRIPTION
A	22OCT2024	APA/VK	PRN: P2024-1785

HORIZONTAL PULL DIRECTION

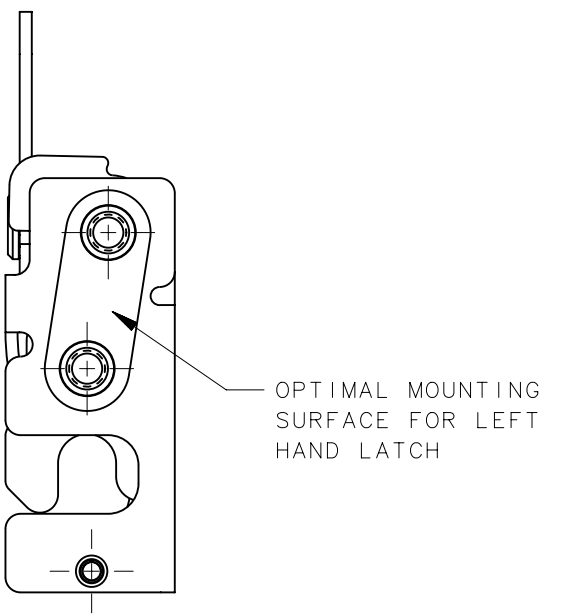
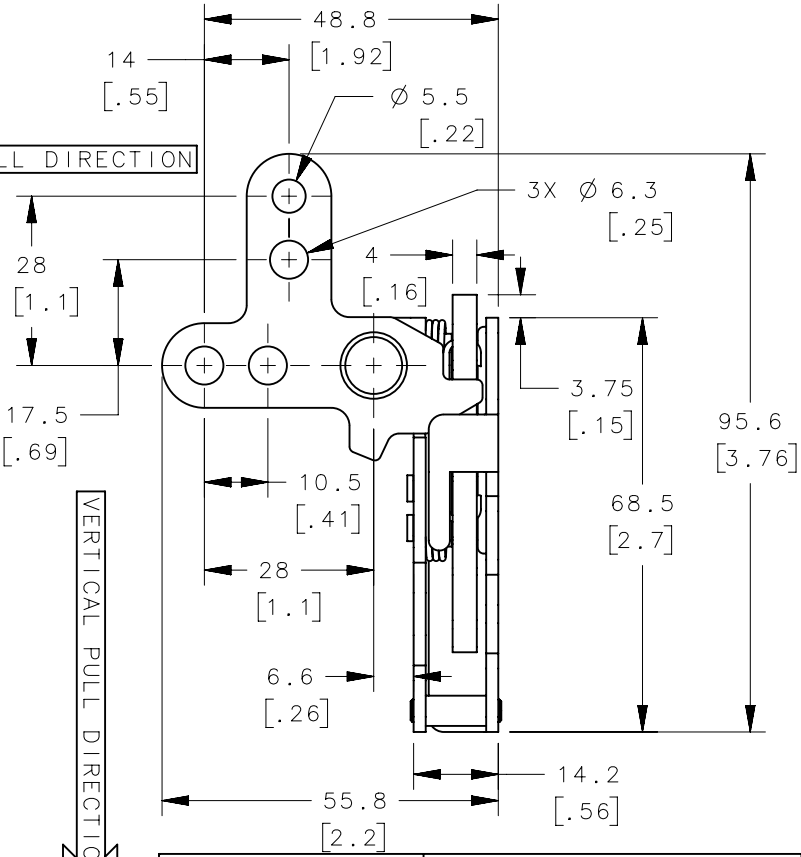
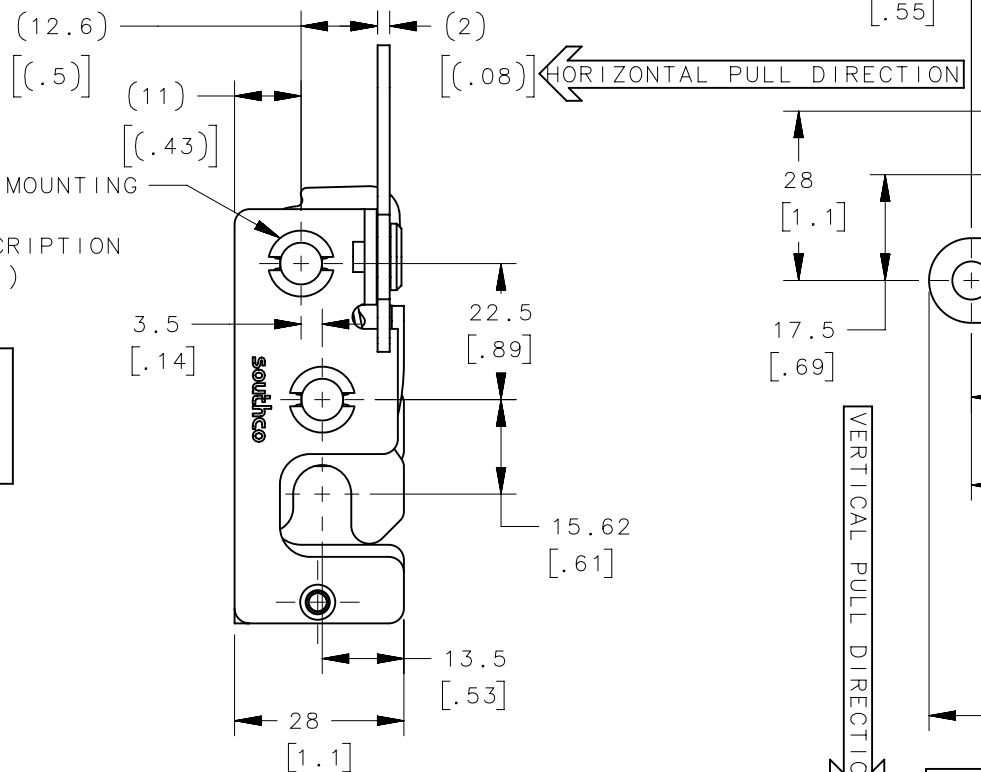
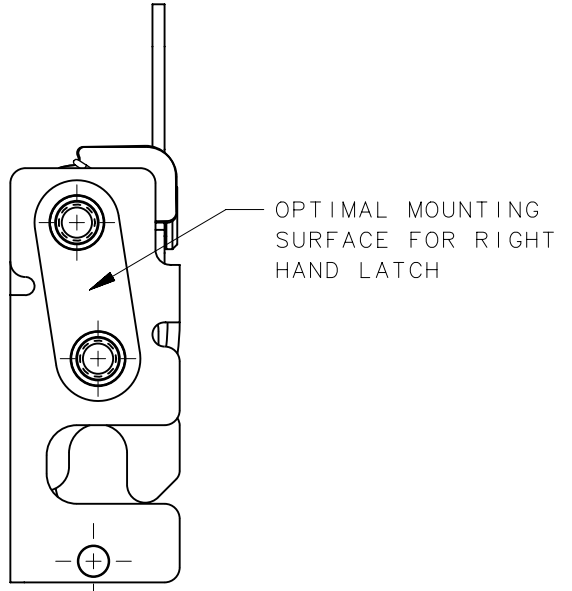
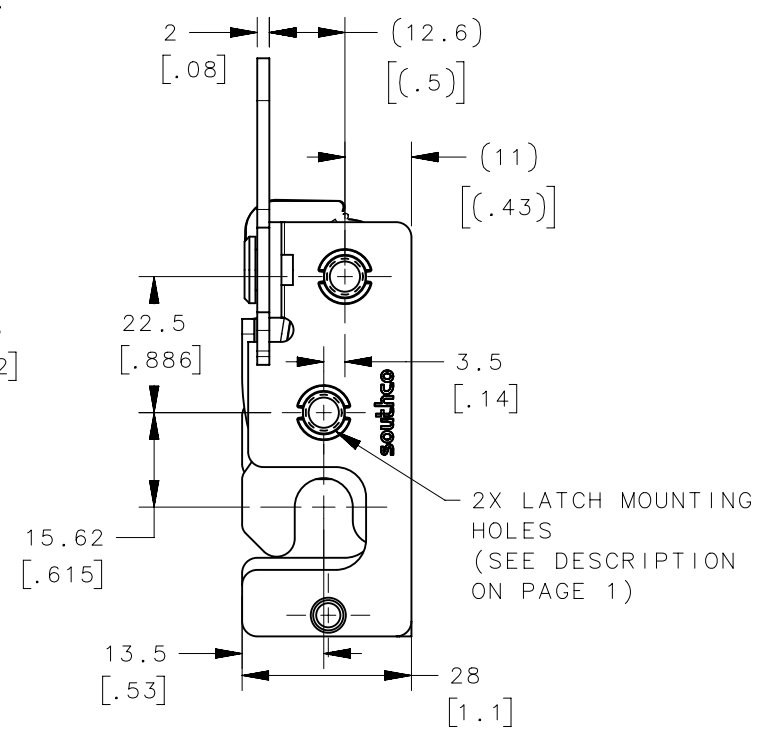
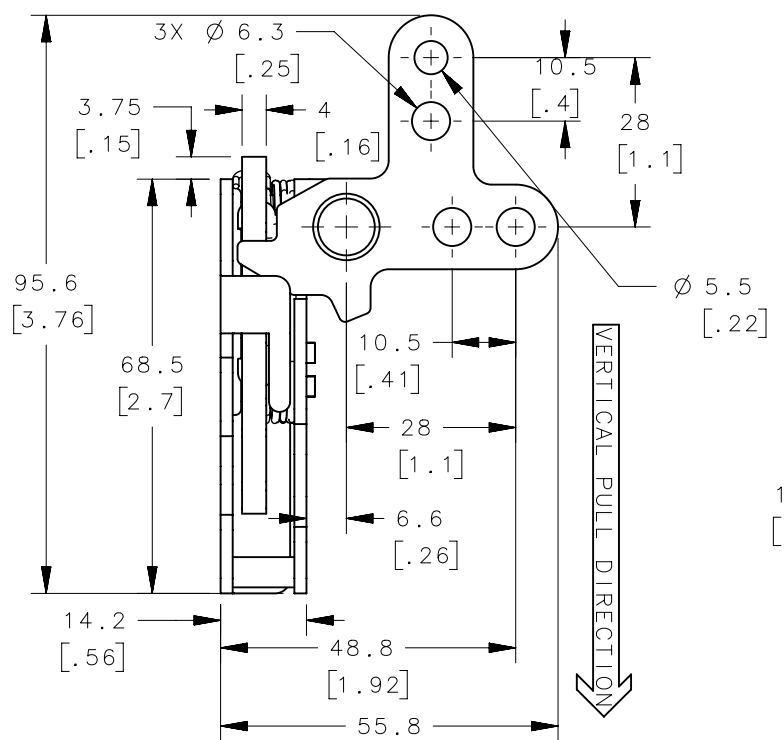

THIRD ANGLE PROJECTION	 CONNECT • CREATE • INNOVATE		
MILLIMETERS [IN]			
TOLERANCES UNLESS OTHERWISE NOTED	DESCRIPTION		
ALL DIMENSIONS WITHOUT TOLERANCES ARE FOR REFERENCE ONLY.	R4 ROTARY LATCH TWO-POINT TRIGGER		
PROPRIETARY ITEM	SIZE	SYSTEM	DWG NO.
EXCEPT FOR USES EXPRESSLY GRANTED IN WRITING, INFORMATION DISCLOSED HEREON IS CONFIDENTIAL AND ALL RIGHTS, PATENT AND OTHERWISE, ARE RESERVED BY SOUTHCO, INC.	B	NX	J-R4-10-301
PER ASME Y14.5M-2009	DRAWN BY	DATE	SCALE SHEET
	APA/VK	18OCT2024	4:5 2 OF 4

±

6

5

4

3

2

1

6

5

4

3

2

1

REVISION HISTORY			
REV	DATE	BY	DESCRIPTION
A	22OCT2024	APA/VK	PRN: P2024-1785

RIGHT HAND LATCH, INTEGRATED BUMPER  
(R4-10-1X-305-XX OR R4-10-3X-305-XX)

2X LATCH MOUNTING HOLES  
(SEE DESCRIPTION ON PAGE 1)

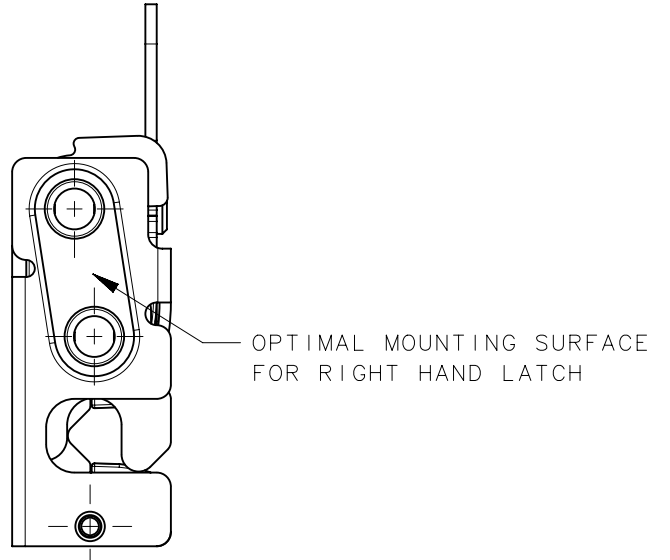
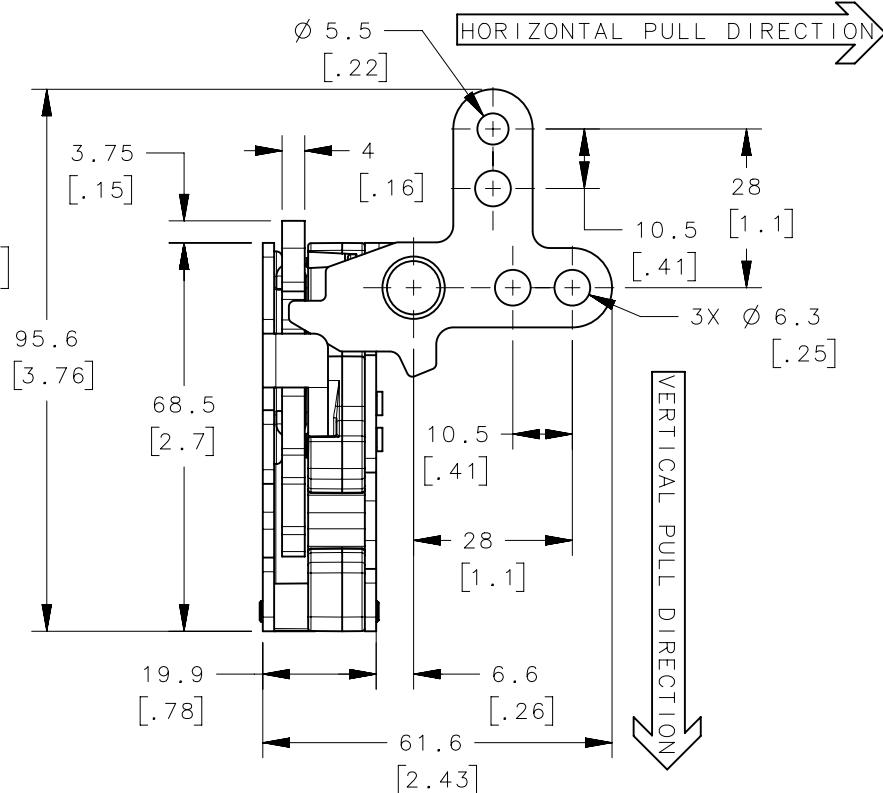
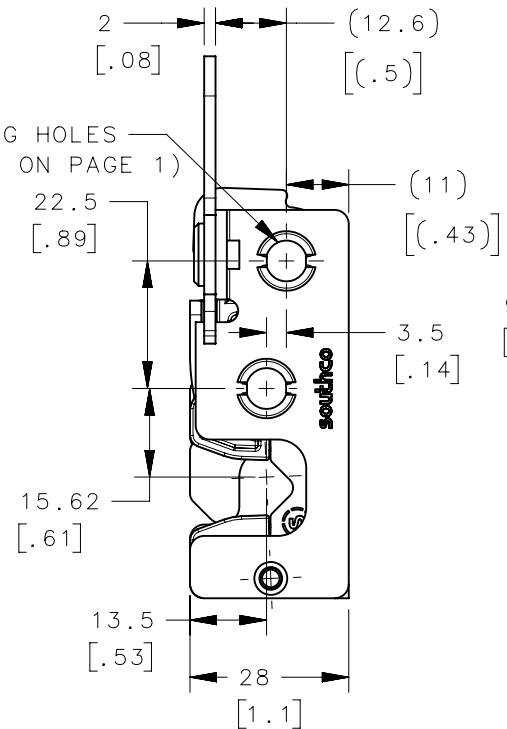

LEFT HAND LATCH, INTEGRATED BUMPER  
(R4-10-2X-305-XX OR R4-10-4X-305-XX)

2X LATCH MOUNTING HOLES  
(SEE DESCRIPTION ON PAGE 1)

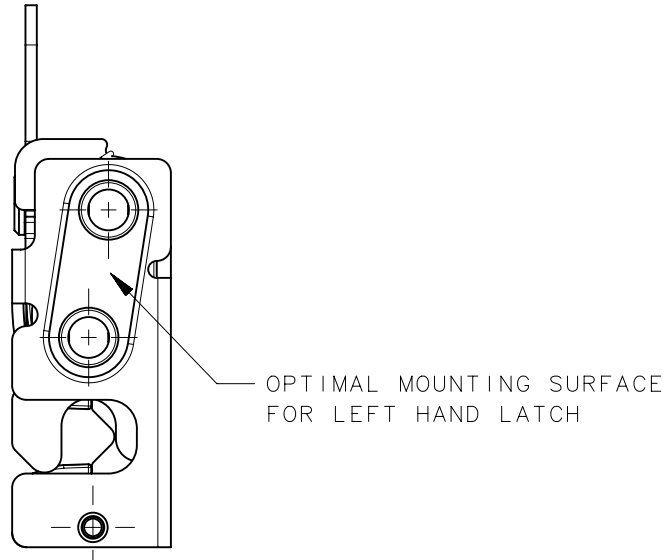
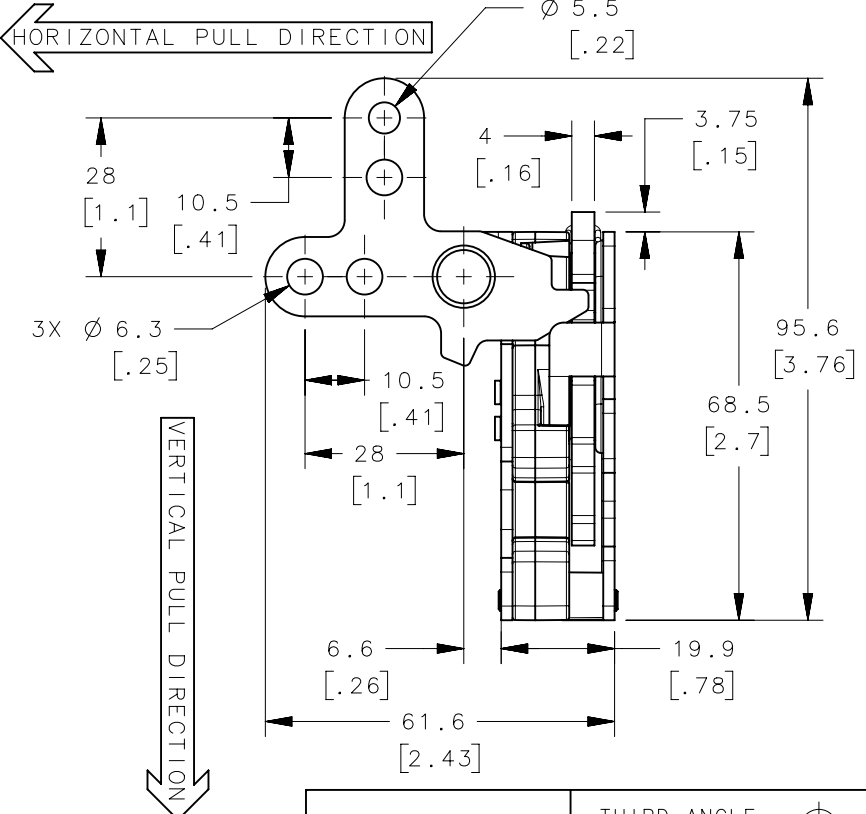
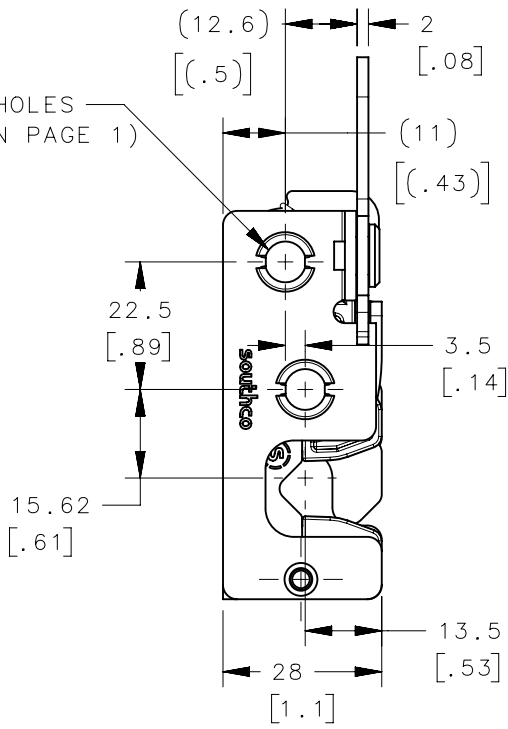

THIRD ANGLE PROJECTION				 CONNECT • CREATE • INNOVATE		
TOLERANCES UNLESS OTHERWISE NOTED				DESCRIPTION		
ALL DIMENSIONS WITHOUT TOLERANCES ARE FOR REFERENCE ONLY.				R4 ROTARY LATCH TWO-POINT TRIGGER		
PROPRIETARY ITEM		SIZE	SYSTEM	DWG NO.		
EXCEPT FOR USES EXPRESSLY GRANTED IN WRITING, INFORMATION DISCLOSED HEREON IS CONFIDENTIAL AND ALL RIGHTS, PATENT AND OTHERWISE, ARE RESERVED BY SOUTHCO, INC.		B	NX	J-R4-10-301		
PER ASME Y14.5M-2009		DRAWN BY	DATE	SCALE	SHEET	
		APA/VK	18OCT2024	1:1	3 OF 4	

6

5

4

3

2

1

REVISION HISTORY			
REV	DATE	BY	DESCRIPTION
A	22OCT2024	APA/VK	PRN: P2024-1785

SHOWING STANDARD RIGHT HAND LATCH

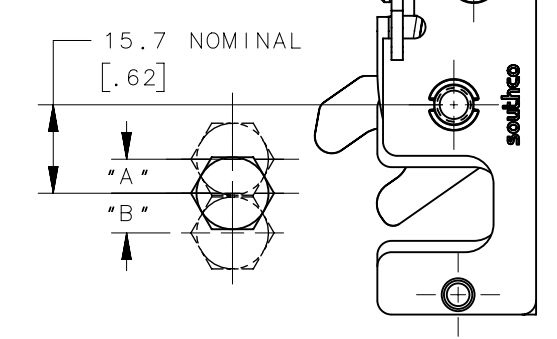
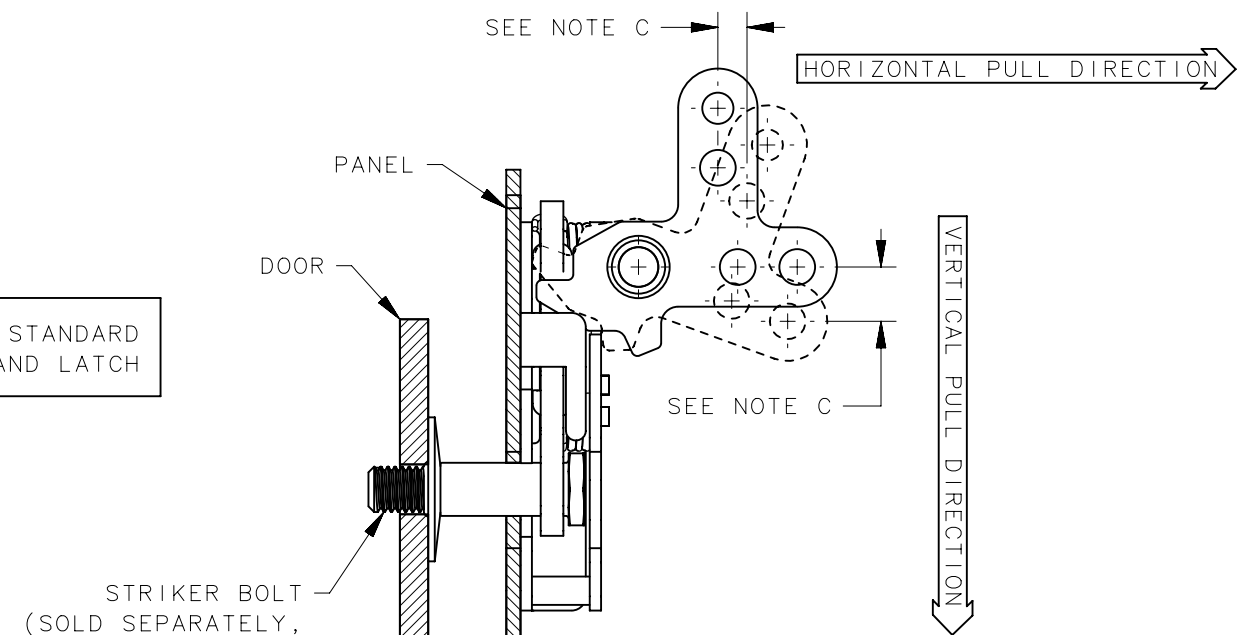

MOUNTING STYLE	MIN PANEL HOLE
0	Ø7.2 [.295]
1	Ø6.8 [.268]
2	Ø6.4 [.252]

PRIMARY STAGE STRIKER ALIGNMENT, STANDARD (SEE NOTE D)

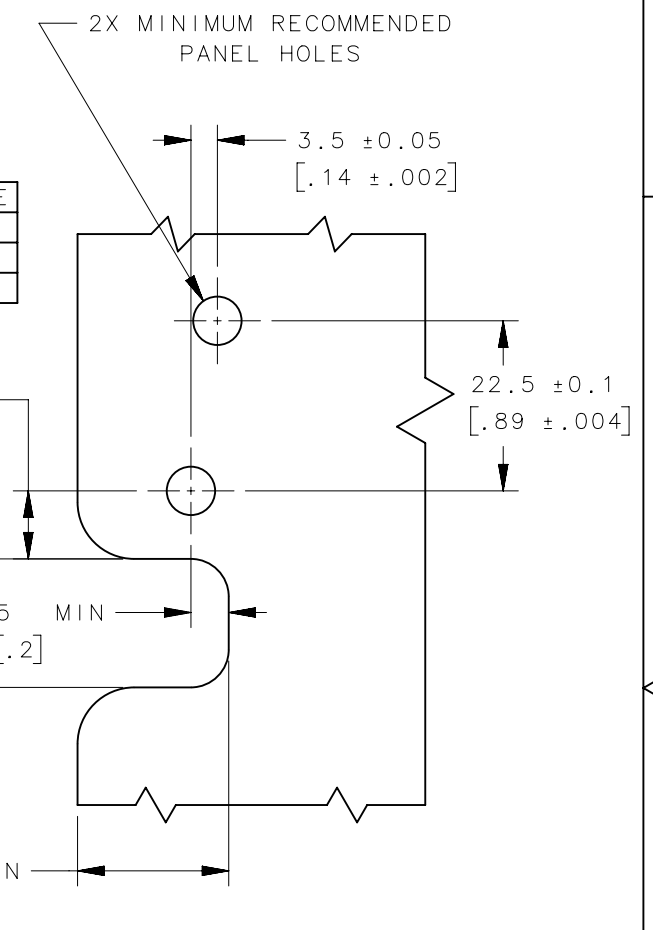

PANEL PREPARATION FOR STANDARD LATCH AND LATCH WITH INTEGRATED BUMPER

SHOWING RIGHT HAND LATCH WITH INTEGRATED BUMPER

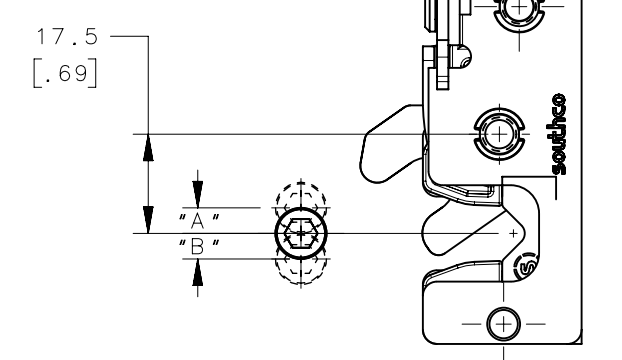
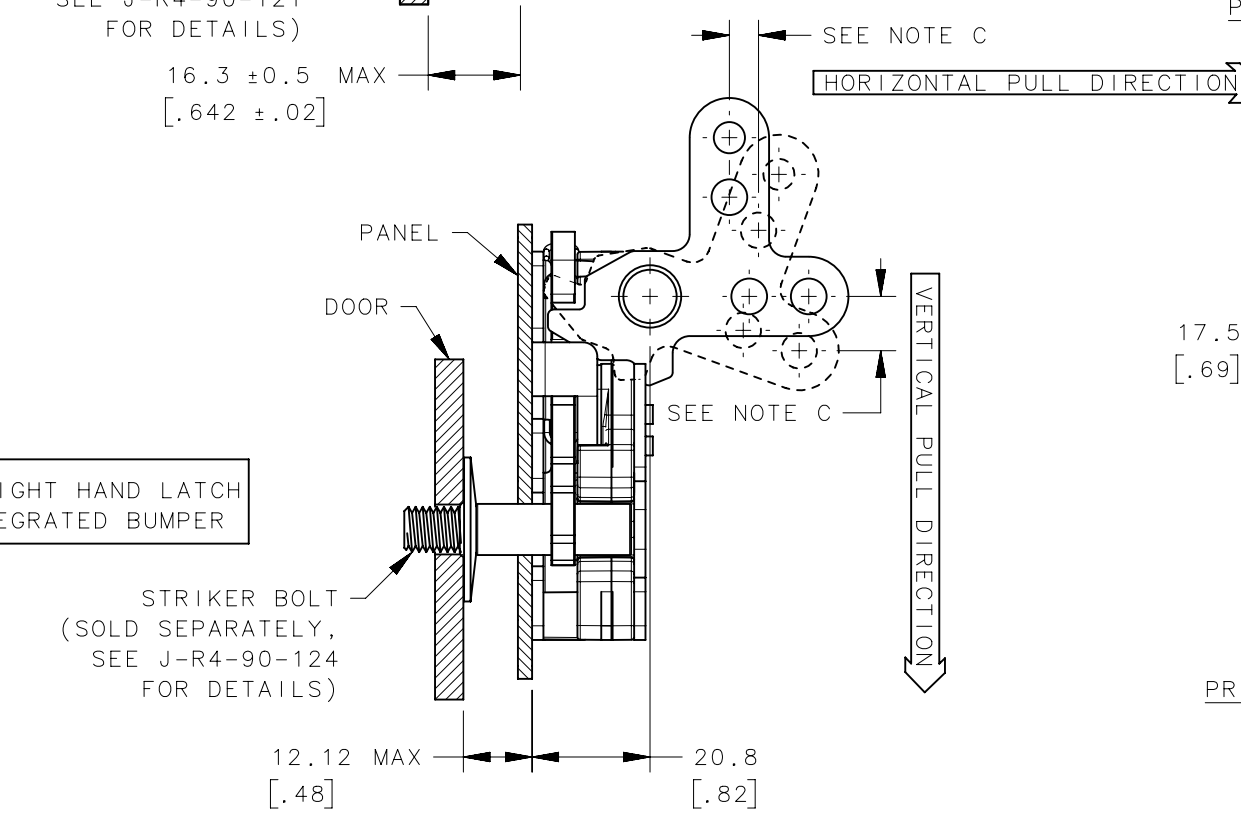

PRIMARY STAGE STRIKER ALIGNMENT WITH INTEGRATED BUMPER (SEE NOTE D)

NOTES:

- C: MINIMUM TRIGGER TRAVEL TO RELEASE THE LATCH OF
  - VERTICAL DIRECTION: 3.9mm [0.15]
  - HORIZONTAL DIRECTION: 2.5mm [0.10]
  - TRIGGER TRAVEL MINIMUM TO HARD STOP OF
    - VERTICAL DIRECTION: 9.4mm [0.37]
    - HORIZONTAL DIRECTION: 5.1mm [0.20]
- D. THESE VIEWS SHOW THE MAXIMUM STRIKER MISALIGNMENT ACCEPTED BY THE LATCH FROM NOMINAL STRIKER POSITION. THEY ASSUME THE STRIKER CENTERLINE IS PERFECTLY PERPENDICULAR TO THE LATCH MOUNTING SURFACE. STRIKER MISALIGNMENT COULD BE FROM MANUFACTURING TOLERANCES OR FROM NON RIGID DOOR SYSTEMS AND THIS REPRESENTS THE MAXIMUM OF BOTH COMBINED.
- E. INTEGRATED BUMPER LATCH MUST USE R4-90-124-XX.

NON-RIGID DOOR	3.7	8.1	5.7	6.3
RIGID DOOR	0	3.6	0.3	0.3
	"A"	"B"	"A"	"B"
	STANDARD		INTEGRATED BUMPER	
CPB NUMBER	-	THIRD ANGLE PROJECTION		
		MILLIMETERS [IN]		
	TOLERANCES UNLESS OTHERWISE NOTED		DESCRIPTION	
	ALL DIMENSIONS WITHOUT TOLERANCES ARE FOR REFERENCE ONLY.		R4 ROTARY LATCH TWO-POINT TRIGGER	
PROPRIETARY ITEM EXCEPT FOR USES EXPRESSLY GRANTED IN WRITING, INFORMATION DISCLOSED HEREON IS CONFIDENTIAL AND ALL RIGHTS, PATENT AND OTHERWISE, ARE RESERVED BY SOUTHCO, INC.	PER ASME Y14.5M-2009	SIZE B	SYSTEM NX	DWG NO. J-R4-10-301
		DRAWN BY APA/VK	DATE 18OCT2024	SCALE 1:1 SHEET 4 OF 4