

NOTES:

1. ALL COMPONENTS ARE RoHS COMPLIANT.
2. FOR USE WITH R4-EM-4X-XXX AND R4-EM-6X-XXX SERIES LATCHES (LIGHT DUTY R4-EM'S).
3. COSMETIC SPECIFICATION:  
ALL SURFACES, UNLESS OTHERWISE NOTED, ARE TO CONFORM TO A CLASS "C" DESIGNATION AS DESCRIBED IN SOUTHCO COSMETIC SPECIFICATION:  
S-121-05 FOR STAINLESS STEEL PARTS

REVISION HISTORY			
REV	DATE	BY	DESCRIPTION
B	03 OCT 11	IR/	PRN: P2011-1267

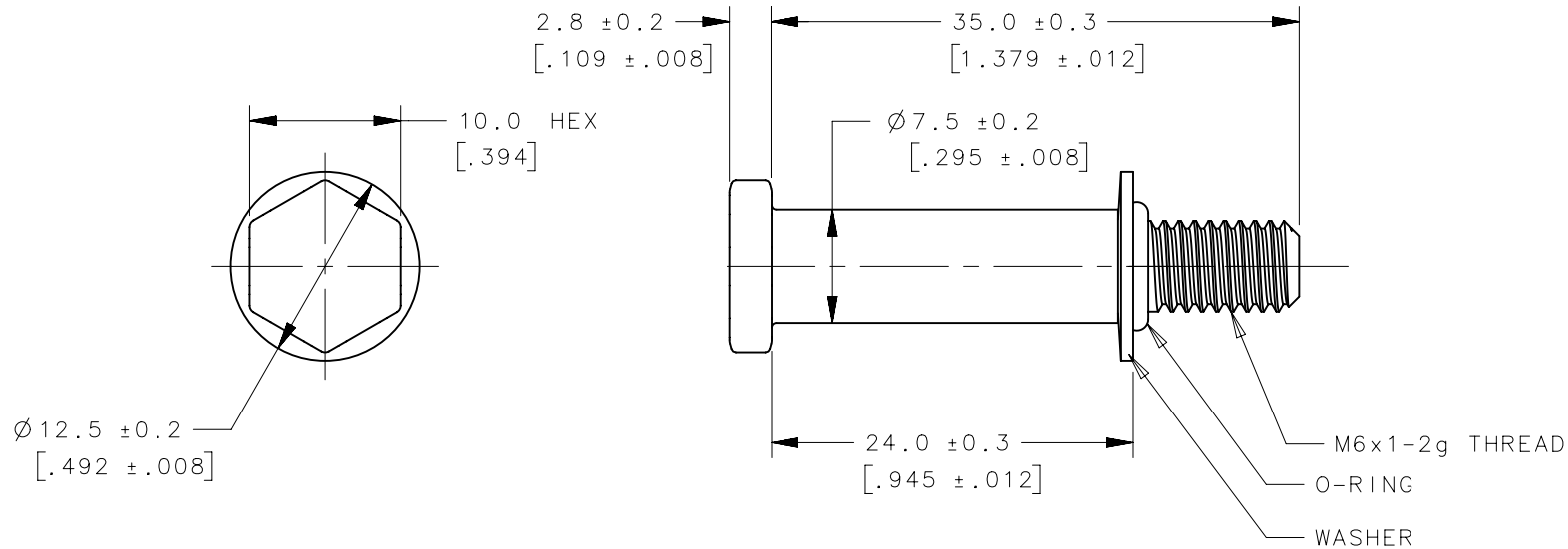
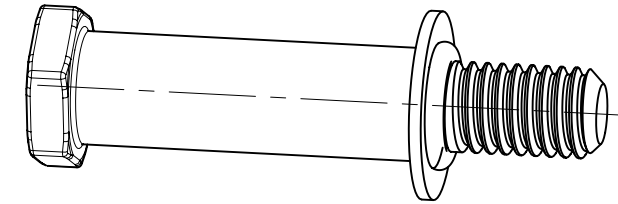

NO.	PART NUMBER	QTY	TYPE OF COMPONENT	MATERIAL	FINISH
3	-	1	BOLT	STAINLESS	PASSIVATED
2	-	1	O-RING	BUNA N	NATURAL
1	-	1	WASHER	STAINLESS	PASSIVATED
-	R4-90-511-20	-	ASSEMBLY	-	-

		THIRD ANGLE PROJECTION		 CONNECT • CREATE • INNOVATE	
		MILLIMETERS [IN]			
SURFACE AREA		TOLERANCES UNLESS OTHERWISE NOTED		DESCRIPTION	
VOLUME		ALL DIMENSIONS WITHOUT TOLERANCES ARE FOR REFERENCE ONLY.		STRIKER BOLT ASSEMBLY, LIGHT DUTY, STAINLESS	
PROPRIETARY ITEM <small>EXCEPT FOR USES EXPRESSLY GRANTED IN WRITING, INFORMATION DISCLOSED HEREON IS CONFIDENTIAL AND ALL RIGHTS, PATENT AND OTHERWISE, ARE RESERVED BY SOUTHCO, INC.</small>		SIZE A4	SYSTEM NX	DWG NO. J-R4-90-511-20	
PER ASME Y14.5M-1994		DRAWN BY IR/	DATE 16 JUN 11	SCALE DNS	SHEET 1 OF 1