

PROPRIETY ITEM - EXCEPT FOR USES EXPRESSLY GRANTED IN WRITING.  
 INFORMATION DISCLOSED HEREON IS CONFIDENTIAL AND ALL RIGHTS  
 PATENT AND OTHERWISE ARE RESERVED BY SOUTHCO, INC.

PART NUMBER ST-12C- [ZZ0] RA [Y] - [XX]

FINISH (XX) PART NUMBER SELECTION	
XX DESIGNATION	FINISH DESCRIPTION
33	NATURAL ZINC
50	BLACK POWDER COAT

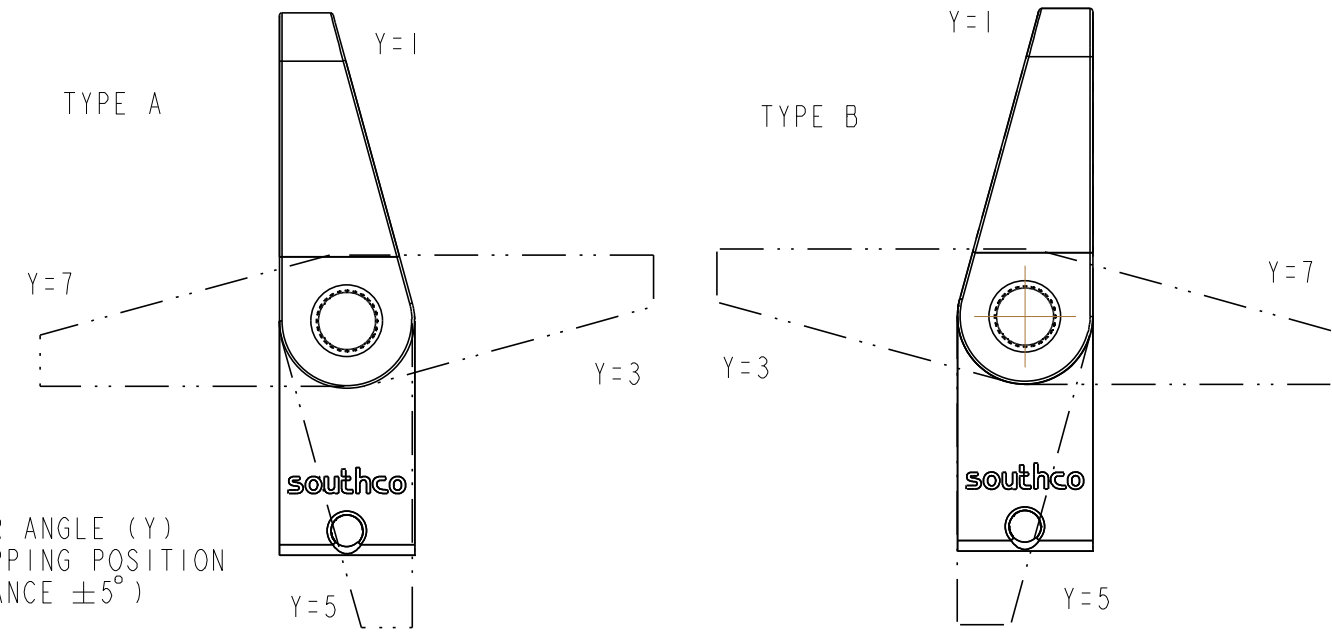

ADAPTER ANGLE (Y)  
 IN SHIPPING POSITION  
 (TOLERANCE  $\pm 5^\circ$ )

FRICTION TORQUE (ZZ0) PART NUMBER SELECTION (TOLERANCE $\pm 20\%$ )		
ZZ0 DESIGNATION	HIGH TORQUE (lb-in)	LOW TORQUE (lb-in)
200	20	13.6
280	28	19.1
360	36	24.6
440	44	30.0

REVISION RECORD			
SYMB	DESCRIPTION	BY	DATE
C	P2008-0269	EN	13MAR08
D	PRN: P2008-1306	JT	21JAN09

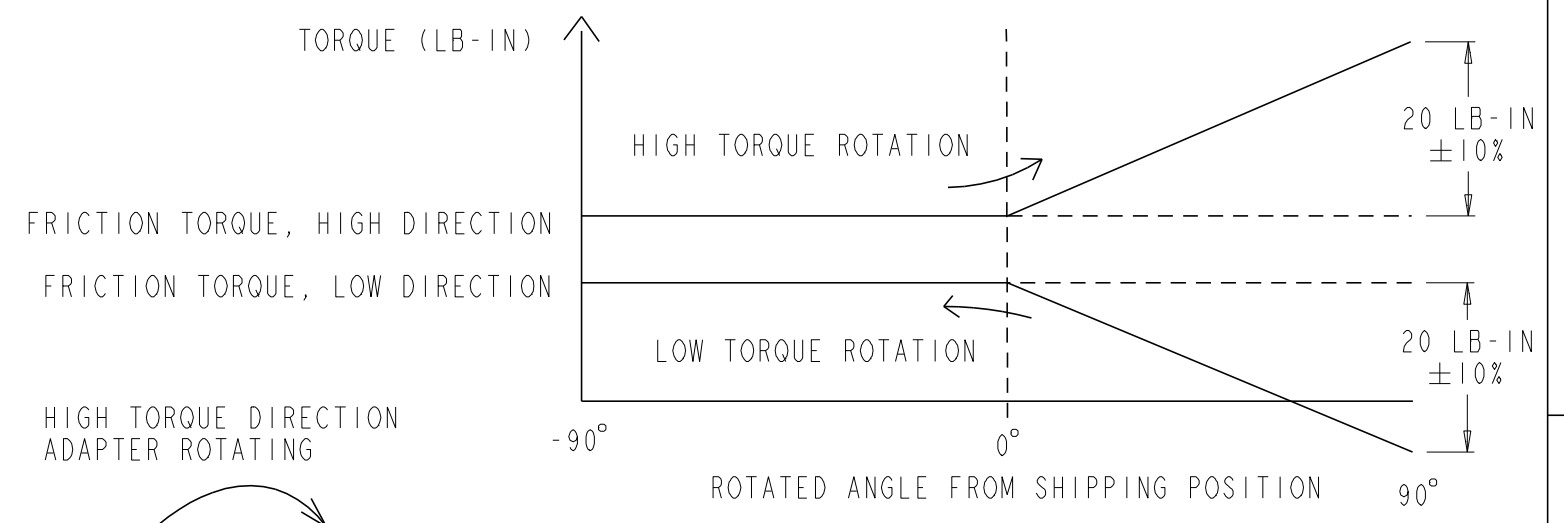

FRICITION TORQUE, HIGH DIRECTION  
 FRICITION TORQUE, LOW DIRECTION

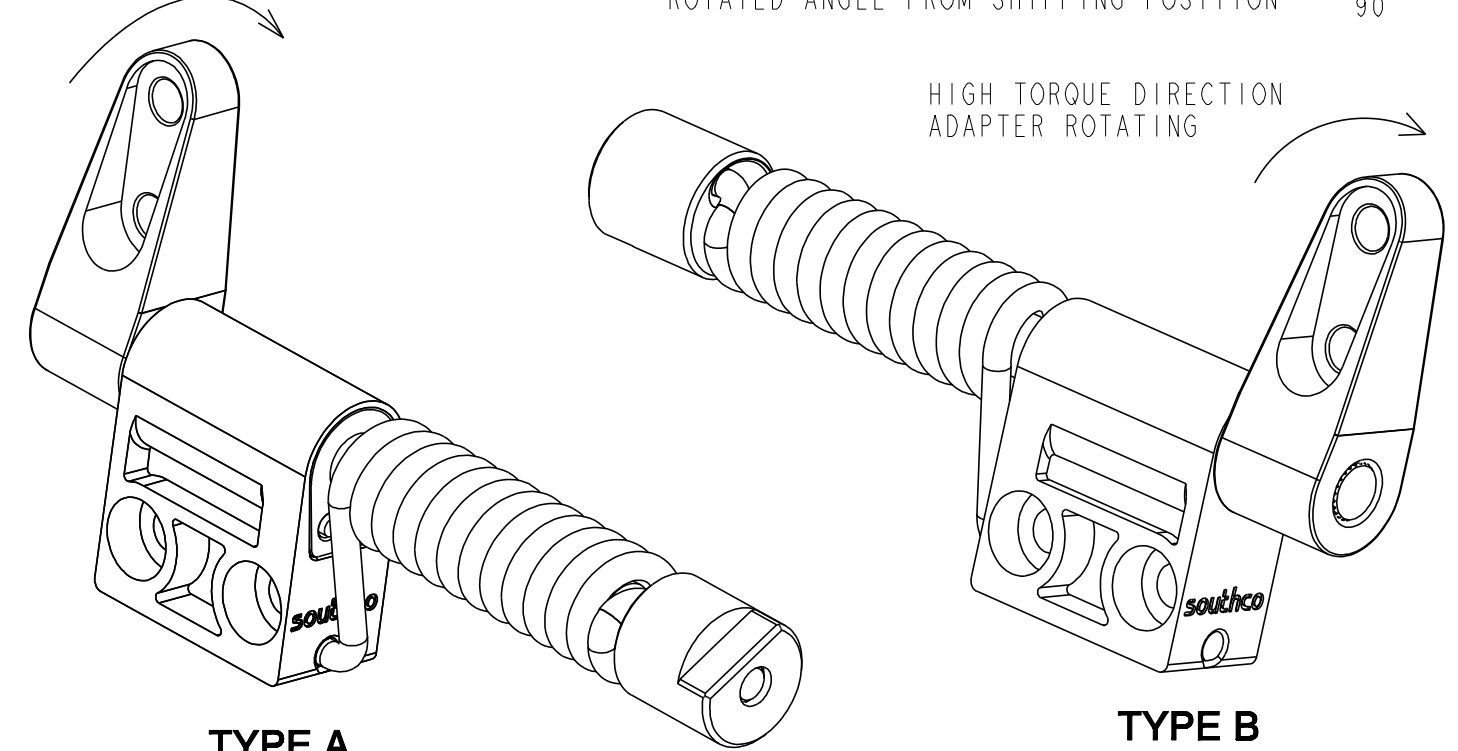

TYPE A  
 PART # ST-12C-200RA1-33 (20 lb-in)  
 (MIRROR OF TYPE B)

TYPE B  
 PART # ST-12C-200RB1-33  
 (SHOWNDIMNSIONED)

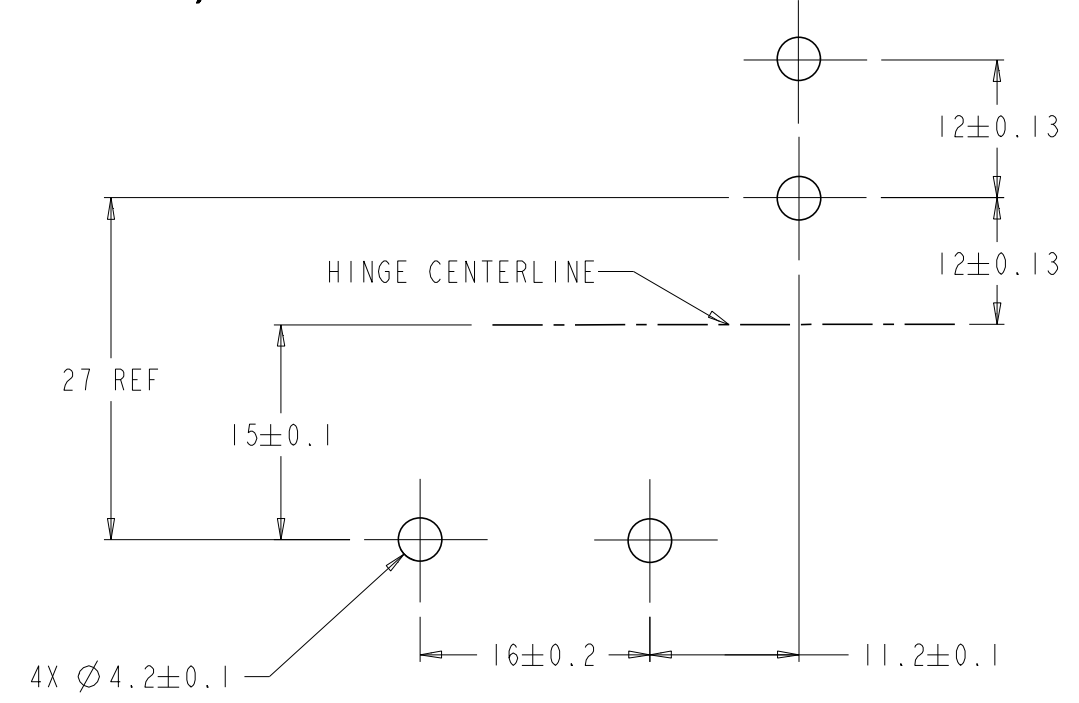
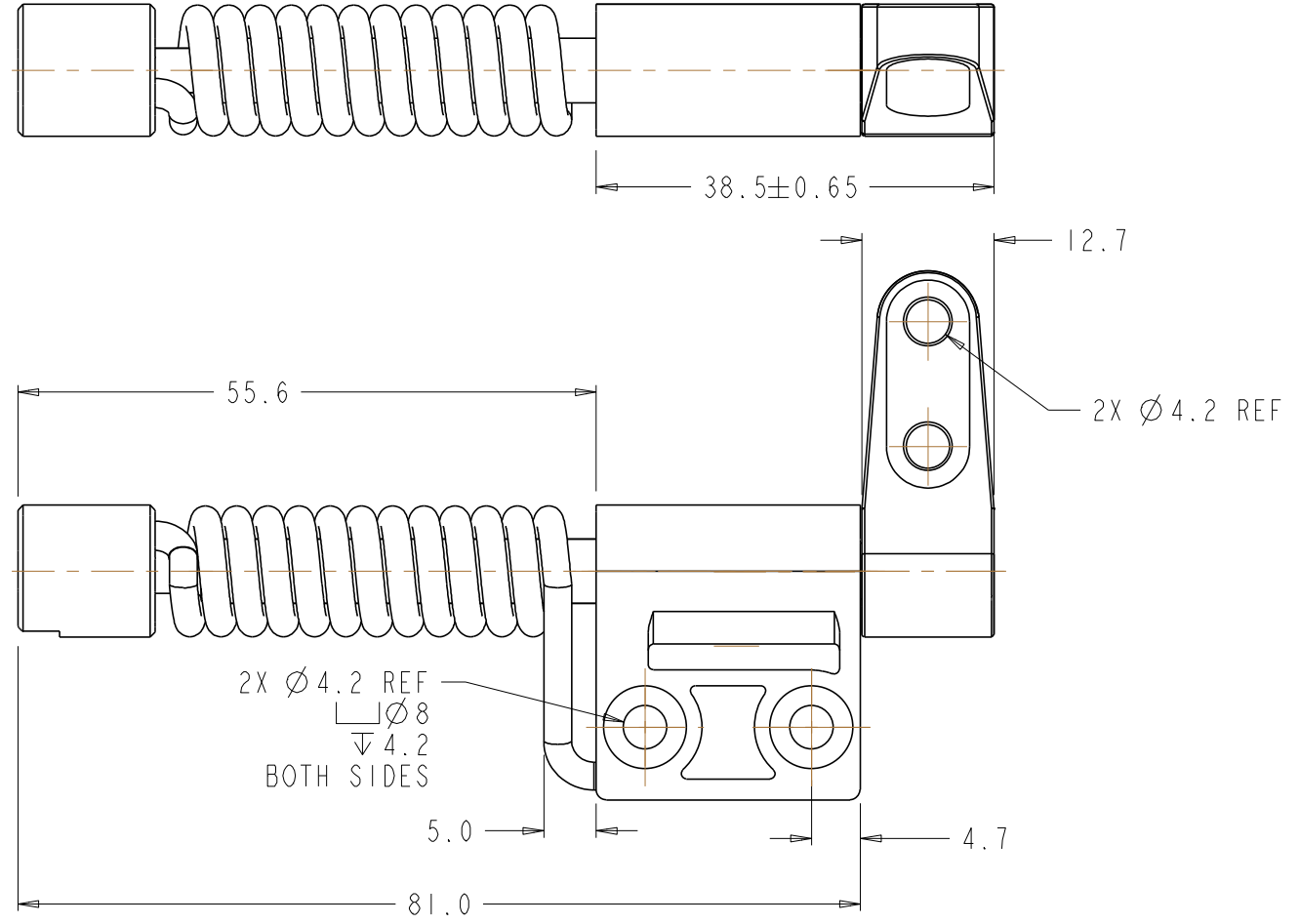
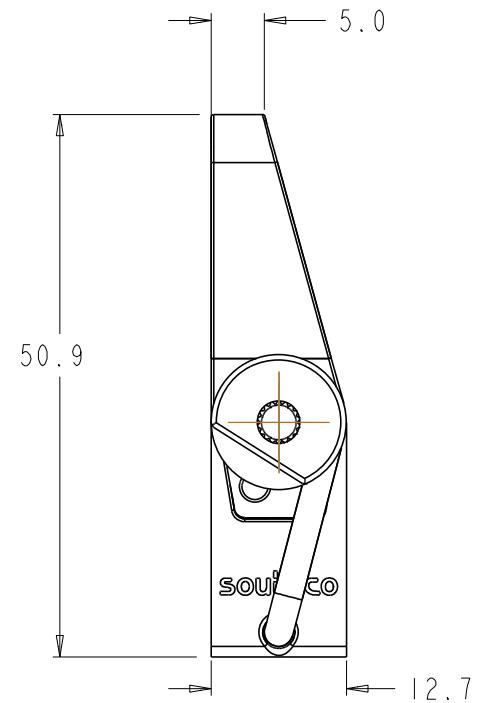

PANEL PREPARATION

- NOTES:
- MATERIAL:  
 HOUSING, ADAPTER, BEARING AND SPRING CAP- ZINC ALLOY  
 FINISH: SEE TABLE  
 SHAFT, PIN AND TORQUE ELEMENTS - HARDENED STEEL  
 SPRING - MUSIC WIRE
  - INSTALL HINGE USING A No. 8 OR M4 SOCKET HEAD CAP SCREW
  - FOR PROPER FUNCTION, ASSEMBLY MUST INCLUDE A MIRRORRED PAIR OF (1) TYPE "A" & (1) TYPE "B" HINGE
  - ALLOWABLE RANGE OF MOTION: 90 DEGREES IN EITHER DIRECTION FROM SHIPPING POSITION

ALL DIMENSIONS  
 ARE IN MILLIMETERS  
 ALL DIMENSIONS  
 WITHOUT  
 TOLERANCES  
 ARE FOR  
 REFERENCE  
 ONLY

<b>southco</b>	
DESIGNER MJC 28NOV06	DRAFTER MJC 28NOV06
MODEL NAME ST-12C-AF	SCALE 1:500
3.2 ALL SURFACES EXCEPT AS NOTED	

TITLE ST-12 COUNTERBALANCED HINGE ASSEMBLY REVERSE	
DWG No J-ST-12C-R	REVISION D
SOUTHCO PART NUMBER AS NOTED	
CALC. WEIGHT	FORMAT C