

REVISION HISTORY

REV	DATE	BY	DESCRIPTION
D	26JUL2019	ZAA/CMS	PRN: P2019-1795

ASSEMBLY PART NUMBER

D9-47-230A<sub>4</sub>-KEEE-P

**K - KNOB STYLE**

K - KNURLED

**EEE - KNOB COLOR**

BLANK - METAL, BRIGHT  
SEE J-47-0-3 FOR  
ADDITIONAL SUFFIXES

**P - PACKAGING**

R - REEL SEE SHEET 4

**A<sub>1</sub> - INSTALL**

2 - 0.9 - 1.5 PANEL ("A")

**A<sub>2</sub> - STUD OD**

3 - Ø 3.5 STUD OD

**A<sub>3</sub> - RECESS**

0 - NO RECESS

**A<sub>4</sub> - STUD LENGTH**

1  
2  
3  
4

Ø 11.7 MAX  
AFTER FINISH

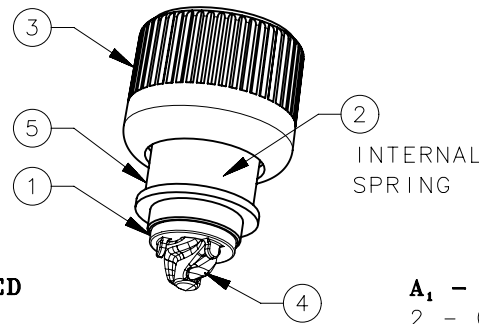
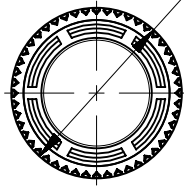

INTERNAL  
SPRING

UNFASTENED

0.8 TOTAL FLOAT

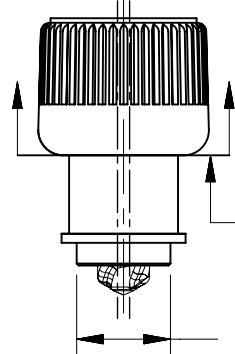

FINISH ADDED  
ABOVE THIS LINE

Ø 6.2

FASTENED

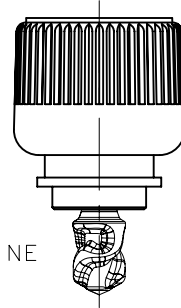

PC BOARD PREPARATION

SOLDERING PAD  
SURFACE AREA

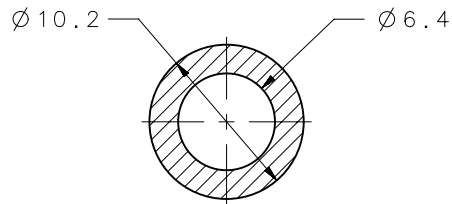

(PASTE TO PAD 1:1)  
SEE NOTE 2

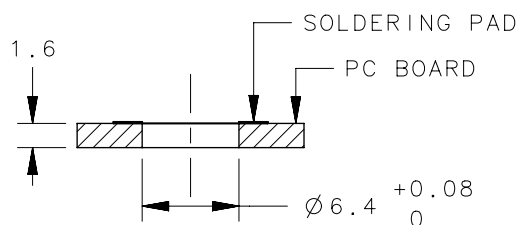

TO INSTALL FASTENER:

1. DRILL A HOLE IN PCB PER PCB PREPARATION VIEW.
2. PRINT THE PC BOARD WITH SOLDER PASTE.  
THE SOLDER PASTE SHOULD COVER THE SOLDER PAD.
3. USE SMT MACHINE TO PICK AND PLACE FASTENER ASSEMBLIES WITH RETAINER INTO PANEL HOLE.
4. RUN THE PCB WITH ATTACHED FASTENER ASSEMBLIES THRU SOLDERING MACHINE TO PERMANENTLY ATTACH THE FASTENERS. THE PC BOARDS WILL CONTINUE THROUGH THE SET UP HEAT SOLDERING CHAMBER AND FINISH THE CYCLE.  
MAXIMUM TEMP 535°F (280°C).
5. REMOVE (SPIN OFF IN CCW DIRECTION) AND DISCARD RETAINERS AFTER SOLDERING IS COMPLETE.
6. SEE SHEET 4 FOR PACKAGING INFORMATION.

MATERIAL AND FINISH: RoHS COMPLIANT

STUD: STEEL, HARDENED,  
ZINC PLATE PLUS SEALER  
FERRULE: STEEL, TIN PLATE  
SPRING: MUSIC WIRE, ZINC PLATE  
KNOB: 6000 SERIES ALUMINUM, NATURAL OR  
POWDER COATED  
RETAINER: UL94-V0 PA9T, NATURAL

5	-	1	FERRULE
4	-	1	STUD
3	-	1	KNOB
2	-	1	SPRING
1	-	1	RETAINER
-	D9-47-230A-KEEE-P	-	ASSEMBLY
NO.	PART NUMBER	QTY	TYPE OF COMPONENT

THIRD ANGLE  
PROJECTION

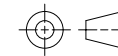

MILLIMETERS [IN]

TOLERANCES UNLESS OTHERWISE NOTED

ALL DIMENSIONS WITHOUT  
TOLERANCES ARE FOR  
REFERENCE ONLY.

PROPRIETARY ITEM  
EXCEPT FOR USES EXPRESSLY GRANTED  
IN WRITING, INFORMATION DISCLOSED  
HEREON IS CONFIDENTIAL AND ALL  
RIGHTS, PATENT AND OTHERWISE,  
ARE RESERVED BY SOUTHCO, INC.

PER ASME Y14.5M-1994

**southco**<sup>®</sup>

CONNECT • CREATE • INNOVATE

DESCRIPTION

QUICK ACCESS FASTENER  
D9-47 SMT STYLE, 3.5 STUD SIZE

SIZE A4 SYSTEM NX DWG NO. J-D9-47-230-K

DRAWN BY IR/ DATE 09 DEC 15 SCALE DNS SHEET 1 OF 4

STUD LENGTH 2 SHOWN IN ALL VIEWS.

REVISION HISTORY			
REV	DATE	BY	DESCRIPTION
D	26JUL2019	ZAA/CMS	PRN: P2019-1795

**WITH SADDLE RECEPTACLE D9-62-11  
(ORDER SEPARATELY)**

$TMT = A+G+3.15$

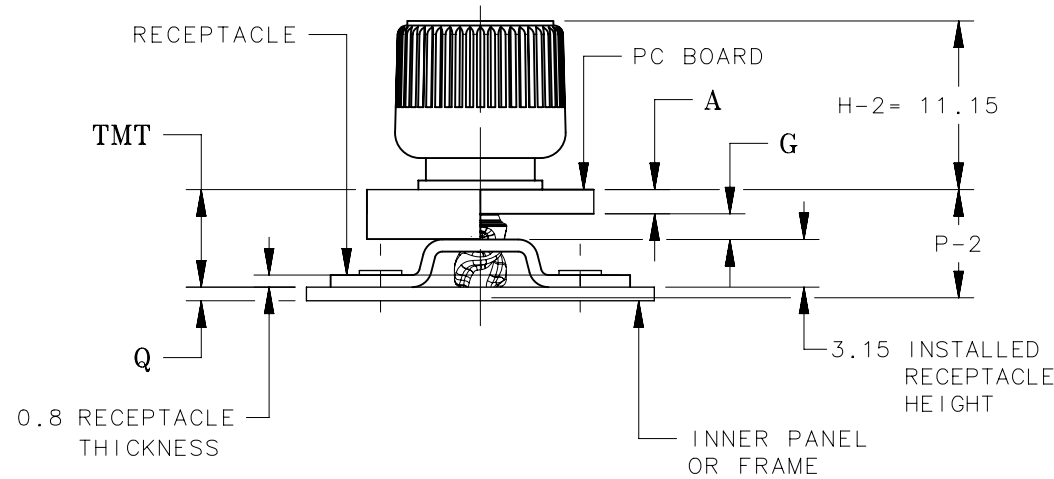

**WITH PRESS-IN RECEPTACLE D9-63-11  
(ORDER SEPARATELY)**

$TMT = A+G+Q$

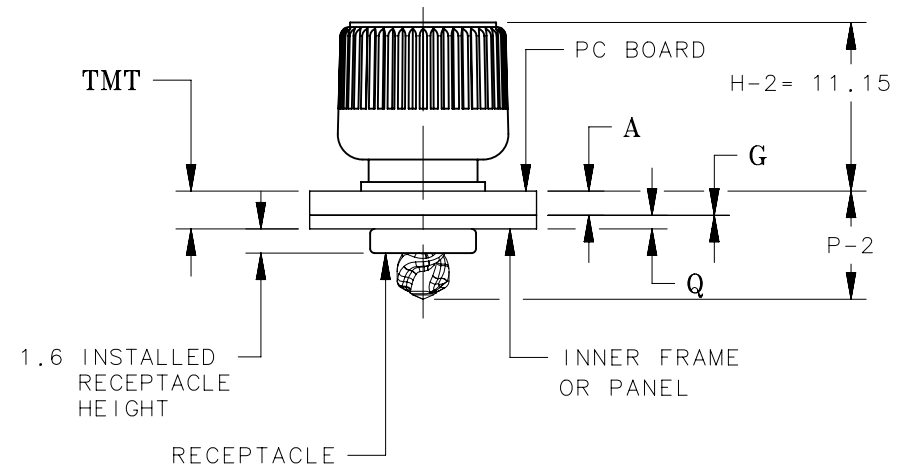

SADDLE STYLE RECEPTACLE (REEL PACKAGE SHOWN)						
STUD ASSEMBLY PART NUMBER	STUD LENGTH	P-1 MAX	P-2 MAX	TMT RANGE		
				MIN.	NOMINAL	MAX.
D9-47-2301-K-R	1	3.8	7.45	4.55	5.25	5.45
D9-47-2302-K-R	2	4.8	8.45	5.55	6.25	6.45
D9-47-2303-K-R	3	5.8	9.45	6.55	7.25	7.45
D9-47-2304-K-R	4	6.8	10.45	7.55	8.25	8.45

SEE J-D9-62 FOR SADDLE RECEPTACLE INFORMATION

PRESS-IN STYLE RECEPTACLE (REEL PACKAGE SHOWN)						
STUD ASSEMBLY PART NUMBER	STUD LENGTH	P-1 MAX	P-2 MAX	TMT RANGE		
				MIN.	NOMINAL	MAX.
D9-47-2301-K-R	1	STUD LENGTH NOT VIABLE				
D9-47-2302-K-R	2	STUD LENGTH NOT VIABLE				
D9-47-2303-K-R	3	5.8	9.45	1.8	2.5	2.7
D9-47-2304-K-R	4	6.8	10.45	2.8	3.5	3.7

SEE J-D9-63 FOR PRESS-IN RECEPTACLE INFORMATION

TMT = TOTAL MATERIAL THICKNESS  
 A = 1.6 MIN PC BOARD THICKNESS  
 G = GAP  
 Q = 0.9 MIN FRAME THICKNESS

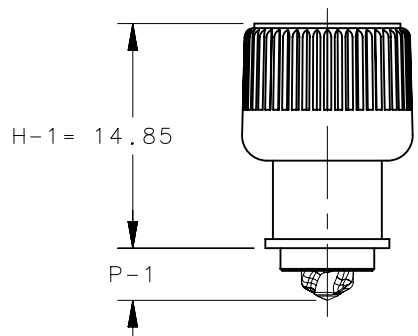

**UNFASTENED**

<p>THIRD ANGLE PROJECTION</p> <p>MILLIMETERS [IN]</p> <p>TOLERANCES UNLESS OTHERWISE NOTED</p> <p>ALL DIMENSIONS WITHOUT TOLERANCES ARE FOR REFERENCE ONLY.</p> <p>PROPRIETARY ITEM</p> <p>EXCEPT FOR USES EXPRESSLY GRANTED IN WRITING, INFORMATION DISCLOSED HEREON IS CONFIDENTIAL AND ALL RIGHTS, PATENT AND OTHERWISE, ARE RESERVED BY SOUTHCO, INC.</p>	<p>PER ASME Y14.5M-1994</p>		<p>DESCRIPTION</p> <p>QUICK ACCESS FASTENER</p> <p>D9-47 SMT STYLE, 3.5 STUD SIZE</p>		<p>SIZE</p> <p>A4</p>	<p>SYSTEM</p> <p>NX</p>	<p>DWG NO.</p> <p>J-D9-47-230-K</p>
	<p>DRAWN BY</p> <p>IR/</p>		<p>DATE</p> <p>09 DEC 15</p>	<p>SCALE</p> <p>DNS</p>	<p>SHEET</p> <p>2 OF 4</p>		

**southco**<sup>®</sup>  
 CONNECT • CREATE • INNOVATE

LENGTH 2 STUD SHOWN IN ALL VIEWS.

REVISION HISTORY			
REV	DATE	BY	DESCRIPTION
D	26JUL2019	ZAA/CMS	PRN: P2019-1795

**WITH FLAT RECEPTACLE D9-61-11  
MOUNTED BELOW PANEL  
(ORDER SEPARATELY)**  
TMT = A+G+Q

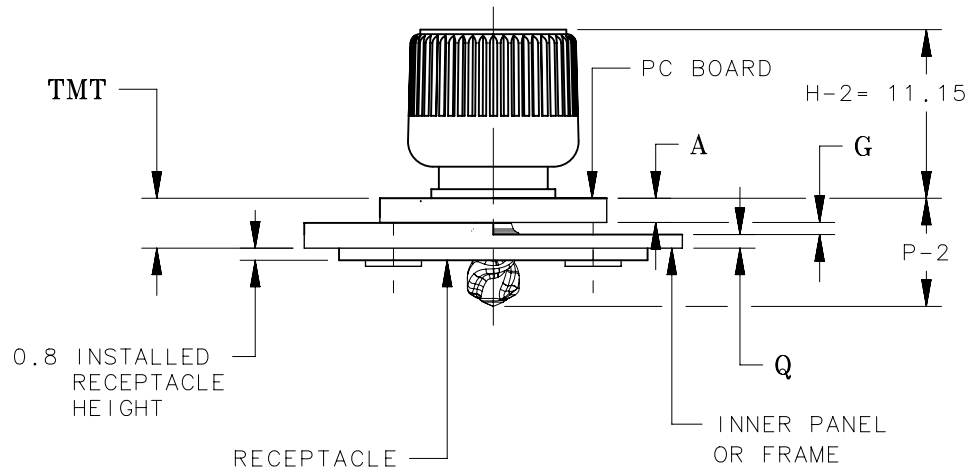

**WITH FLAT RECEPTACLE D9-61-11  
MOUNTED ABOVE PANEL  
(ORDER SEPARATELY)**  
TMT = A+G+0.8

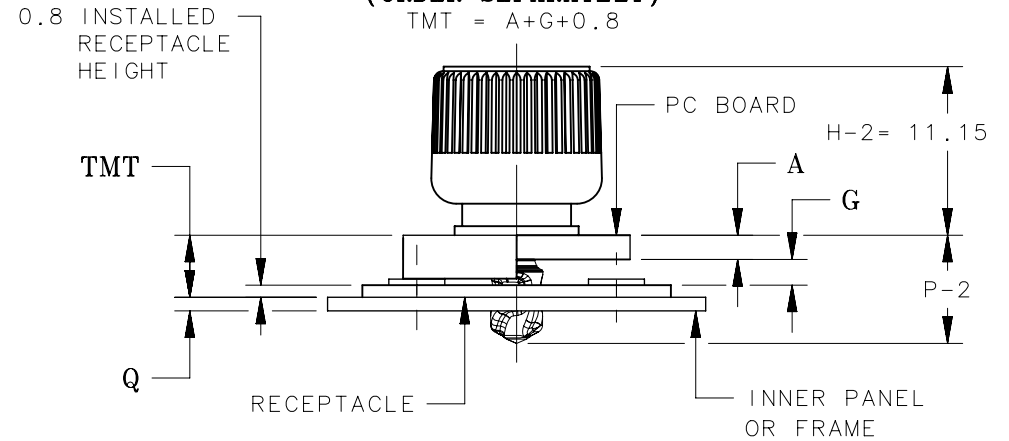

FLAT RECEPTACLE MOUNTED BELOW PANEL (REEL PACKAGE SHOWN)						
STUD ASSEMBLY PART NUMBER	STUD LENGTH	P-1 MAX	P-2 MAX	TMT RANGE		
				MIN.	NOMINAL	MAX.
D9-47-2301-K-R	1	STUD LENGTH NOT VIABLE				
D9-47-2302-K-R	2	4.8	8.45	2.4	3.1	3.3
D9-47-2303-K-R	3	5.8	9.45	3.4	4.1	4.3
D9-47-2304-K-R	4	6.8	10.45	4.4	5.1	5.3

SEE J-D9-61 FOR FLAT RECEPTACLE INFORMATION

FLAT RECEPTACLE MOUNTED ABOVE PANEL (REEL PACKAGE SHOWN)						
STUD ASSEMBLY PART NUMBER	STUD LENGTH	P-1 MAX	P-2 MAX	TMT RANGE		
				MIN.	NOMINAL	MAX.
D9-47-2301-K-R	1	3.8	7.45	2.2	2.9	3.1
D9-47-2302-K-R	2	4.8	8.45	3.2	3.9	4.1
D9-47-2303-K-R	3	5.8	9.45	4.2	4.9	5.1
D9-47-2304-K-R	4	6.8	10.45	5.2	5.9	6.1

SEE J-D9-61 FOR FLAT RECEPTACLE INFORMATION

TMT = TOTAL MATERIAL THICKNESS  
A = 1.6 MIN PC BOARD THICKNESS  
G = GAP  
Q = 0.9 MIN FRAME THICKNESS

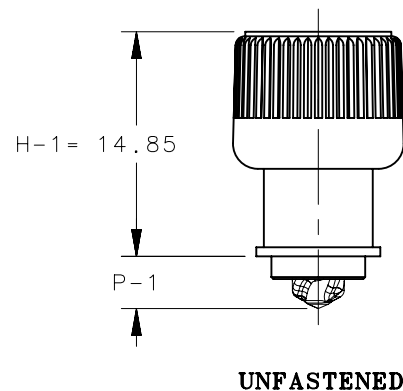

	THIRD ANGLE PROJECTION			 CONNECT • CREATE • INNOVATE	
	MILLIMETERS [IN]				
	TOLERANCES UNLESS OTHERWISE NOTED	DESCRIPTION			
	ALL DIMENSIONS WITHOUT TOLERANCES ARE FOR REFERENCE ONLY.	QUICK ACCESS FASTENER D9-47 SMT STYLE, 3.5 STUD SIZE			
	PROPRIETARY ITEM	SIZE	SYSTEM	DWG NO.	
	EXCEPT FOR USES EXPRESSLY GRANTED IN WRITING, INFORMATION DISCLOSED HEREON IS CONFIDENTIAL AND ALL RIGHTS, PATENT AND OTHERWISE, ARE RESERVED BY SOUTHCO, INC.	A4	NX	J-D9-47-230-K	
	PER ASME Y14.5M-1994	DRAWN BY	DATE	SCALE	SHEET
		IR/	09 DEC 15	DNS	3 OF 4

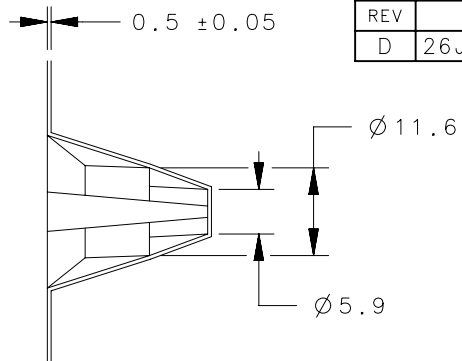
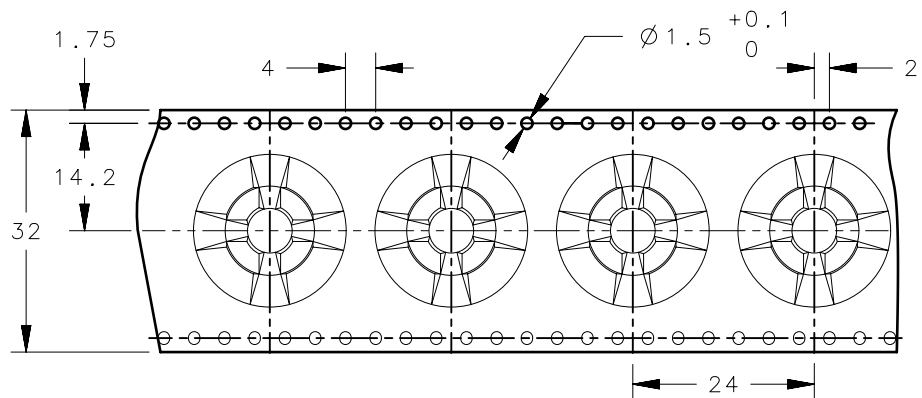

REVISION HISTORY			
REV	DATE	BY	DESCRIPTION
D	26JUL2019	ZAA/CMS	PRN: P2019-1795

REEL PACKAGE: 13 INCH REEL TAPE PER EIA-481, 100 PIECES PER REEL  
 MATERIAL: POLYSTYRENE, BLACK  
 ALL TOLERANCE +/- 0.10 UNLESS NOTED

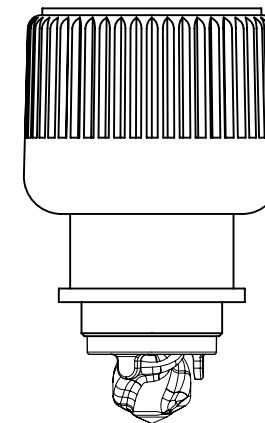

WITH RETAINER HOLDING KNOB  
 IN WAVE SOLDER POSITION

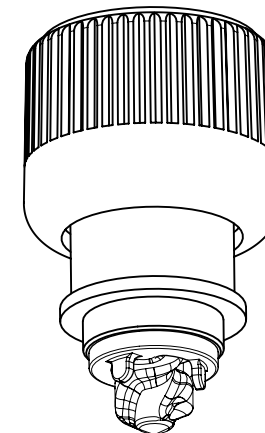

	THIRD ANGLE PROJECTION	 CONNECT • CREATE • INNOVATE	
	MILLIMETERS [IN]		
	TOLERANCES UNLESS OTHERWISE NOTED	DESCRIPTION	
	ALL DIMENSIONS WITHOUT TOLERANCES ARE FOR REFERENCE ONLY.	QUICK ACCESS FASTENER D9-47 SMT STYLE, 3.5 STUD SIZE	
PROPRIETARY ITEM EXCEPT FOR USES EXPRESSLY GRANTED IN WRITING, INFORMATION DISCLOSED HEREON IS CONFIDENTIAL AND ALL RIGHTS, PATENT AND OTHERWISE, ARE RESERVED BY SOUTHCO, INC.	PER ASME Y14.5M-1994	SIZE A4	SYSTEM NX
		DWG NO. J-D9-47-230-K	
		DRAWN BY IR/	DATE 09 DEC 15
		SCALE DNS	SHEET 4 OF 4