

SOUTHCO PERFORMANCE GUIDELINES:
 THE PERFORMANCE GUIDELINES SHOWN ON THIS PAGE ARE SUPPLIED AS A GENERAL GUIDE ONLY, AS CONDITIONS VARY WITH EACH APPLICATION AND METHOD OF INSTALLATION. STRENGTH DATA GIVEN IS FOR FAILURE OF PRODUCT OR FOR SUFFICIENT DEFORMATION TO MAKE THE PRODUCT INOPERABLE, NO SAFETY FACTOR HAS BEEN APPLIED. IT IS RECOMMENDED THAT THE USER REQUEST A PRODUCT SAMPLE FOR TESTING TO DETERMINE THE SUITABILITY OF THE PRODUCT FOR THE PURPOSE INTENDED AND USER'S PARTICULAR APPLICATION.

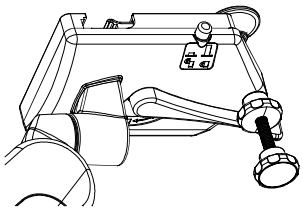
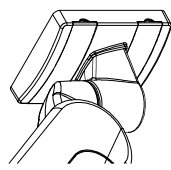
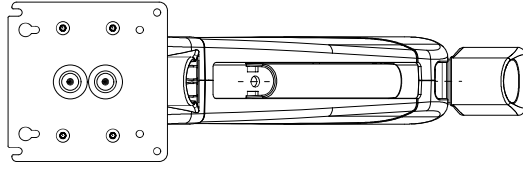
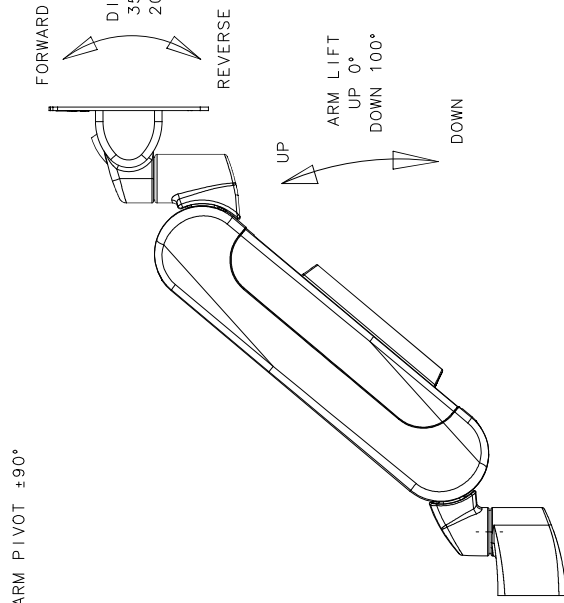
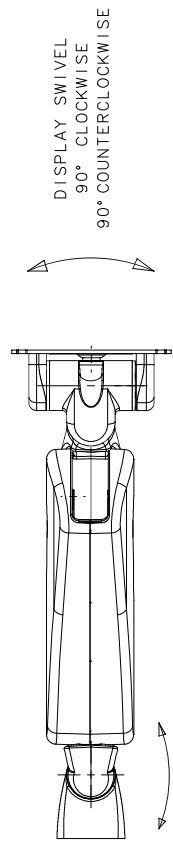
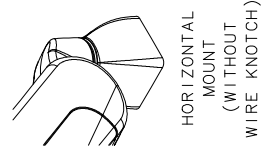
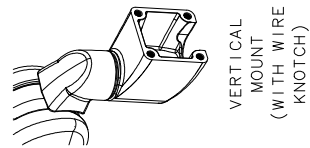
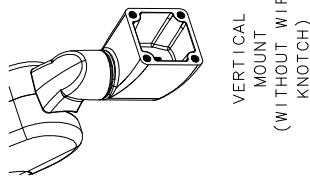

NOTES:

- TEST DATA FROM THE FOLLOWING SOUTHCO TEST REPORTS:
 <1> TRAV-18175 <5> TRAV-26657
 <2> TRAV-41258 <6> TRAV-38001
 <3> TRAV-41839 <7> TRAV-37486
 <4> TRAV-41840
 *ENGINEERING DERIVED VALUE FROM SUPPORTING TEST DOCUMENTS.

NOTE: CYCLE AND LOAD TESTS WERE CONDUCTED WITH WALL (VERTICAL PLANE) MOUNT VERSIONS. ULTIMATE LOAD TEST WAS CONDUCTED WITH THE DISPLAY PARALLEL TO THE MOUNTING PLANE AT THE LARGEST LINEAR DISTANCE.

- DISPLAY MOUNTING SYSTEM CYCLE TEST AS COMBINED MOTIONS AS FOLLOWS:
 DISPLAY TILT FORWARD 35° AND REVERSE 20°
 DISPLAY SWIVEL ±90° FROM POSITION SHOWN.
 ARM PIVOT ±90° FROM POSITION SHOWN.
 CYCLE TESTING CONDUCTED WITH A 9.98 lkg (22 lbm) TEST DISPLAY PANEL ATTACHED FOR THE CYCLE TEST.

- TILT TORQUE SPECIFICATION AT A CYCLE LIFE OF 20,000 CYCLES AT 25% DUTY CYCLE AT SPEEDS LESS THAN 15 RPM.

NOTE: TILT FORWARD AND TILT REVERSE TORQUE MEASURED WITH THE DISPLAY IN THE VERTICAL (0°) POSITION. THE TILT TORQUE IN THE FORWARD AND REVERSE DIRECTION VARIES WITH THE COUNTERBALANCE, (WHEN EQUIPPED).

- PART NUMBERS: YY = 50, 60, 61, 66, 76 OR 78
 YY = SEE SOUTHCO DRAWING J-AV-0-3 FOR COLOR DESIGNATION SUFFIX.

HOUSING STYLE	VERTICAL MOUNT PART NUMBERS (SEE NOTES)	DISPLAY TILT TORQUE N·m (lb·ft)	DISPLAY TILT TORQUE N·m (lb·ft)	SWIVEL TORQUE <5> N·m (lb·ft)	ARM PIVOT TORQUE <5> N·m (lb·ft)	WORKING LOAD RATING PER UL 1678 N (lbm)	AVERAGE ULTIMATE LOAD N (lbm)	SWIVEL AND PIVOT STOP ULTIMATE TORQUE <1,7> N·m (lb·ft)	CYCLE LIFE
VERTICAL WITHOUT WIRE NOTCH	AV-D32-30V101-YY	7.56 (1.56)	2.26 (0.52)	4.29 N·m (38 lb·ft)	6.0 N·m (53.1 lb·ft)	70 (15.7)	<5>	<1,2,3,4,5,6>	20,000
	AV-D32-30V102-YY	15.36 (3.36)	2.26 (0.52)	38 lb·ft	NOMINAL / 4.2 N·m (37.1 lb·ft)	100 (22.5)			
	AV-D32-30V103-YY	8.58 (1.86)	6.01 (53.2)	2.71 N·m (24 lb·ft)	MINIMUM	70 (15.7)			
VERTICAL WITH WIRE NOTCH	AV-D32-30V111-YY	7.9 (1.7)	2.2 (0.5)	4.29 N·m (38 lb·ft)	6.0 N·m (53.1 lb·ft)	70 (15.7)			
	AV-D32-30V112-YY	15.36 (3.36)	2.26 (0.52)	38 lb·ft	NOMINAL / 4.2 N·m (37.1 lb·ft)	100 (22.5)			
	AV-D32-30V113-YY	8.58 (1.86)	6.01 (53.2)	2.71 N·m (24 lb·ft)	MINIMUM	70 (15.7)			
HORIZONTAL WITHOUT WIRE NOTCH	AV-D32-30V121-YY	7.9 (1.7)	2.2 (0.5)	4.29 N·m (38 lb·ft)	6.0 N·m (53.1 lb·ft)	70 (15.7)			
	AV-D32-30V122-YY	15.36 (3.36)	2.26 (0.52)	38 lb·ft	NOMINAL / 4.2 N·m (37.1 lb·ft)	100 (22.5)			
	AV-D32-30V132-YY	8.58 (1.86)	6.01 (53.2)	2.71 N·m (24 lb·ft)	MINIMUM	70 (15.7)			
HORIZONTAL WITH WIRE NOTCH	AV-D32-30V141-YY	7.9 (1.7)	2.2 (0.5)	4.29 N·m (38 lb·ft)	6.0 N·m (53.1 lb·ft)	70 (15.7)			
	AV-D32-30V142-YY	15.36 (3.36)	2.26 (0.52)	38 lb·ft	NOMINAL / 4.2 N·m (37.1 lb·ft)	100 (22.5)			
	AV-D32-30V161-YY	8.58 (1.86)	6.01 (53.2)	2.71 N·m (24 lb·ft)	MINIMUM	70 (15.7)			
POLE MOUNT	AV-D32-30V162-YY	15.36 (3.36)	2.26 (0.52)	38 lb·ft	NOMINAL / 4.2 N·m (37.1 lb·ft)	100 (22.5)			
	AV-D32-30V163-YY	8.58 (1.86)	6.01 (53.2)	2.71 N·m (24 lb·ft)	MINIMUM	70 (15.7)			
	AV-D32-30V172-YY	15.36 (3.36)	2.26 (0.52)	38 lb·ft	NOMINAL / 4.2 N·m (37.1 lb·ft)	100 (22.5)			
DIN RAIL MOUNT	AV-D32-30V173-YY	8.58 (1.86)	6.01 (53.2)	2.71 N·m (24 lb·ft)	MINIMUM	70 (15.7)			
	AV-D32-30V174-YY	15.36 (3.36)	2.26 (0.52)	38 lb·ft	NOMINAL / 4.2 N·m (37.1 lb·ft)	100 (22.5)			

THIRD ANGLE PROJECTION	
MILLIMETERS (IN)	
TOLERANCES UNLESS OTHERWISE NOTED	
ALL DIMENSIONS WITHOUT TOLERANCES ARE FOR REFERENCE ONLY.	
APPROVALS: DATE	
DESIGNED BY: [REDACTED]	
CHECKED BY: [REDACTED]	
DATE: 12/03/2019	
SCALE: 1:1	

southco
 CONNECT · CREATE · INNOVATE

HINGE & CONTROLLED MOTION DEVICE
 STANDARD ARTICULATING ARM
 PART NUMBER: TD-AV-D32-30V1XY-J
 DRAWN BY: GEA