

| REVISION HISTORY |           |         |                 |
|------------------|-----------|---------|-----------------|
| REV              | DATE      | BY      | DESCRIPTION     |
| F                | 11MAY2020 | ABK/AJT | PRN: P2020-0869 |

SOUTHCO PERFORMANCE GUIDELINES

THE PERFORMANCE GUIDELINES SHOWN ON THIS PAGE ARE SUPPLIED AS A GENERAL GUIDE ONLY. AS CONDITIONS VARY WITH EACH APPLICATION AND METHOD OF INSTALLATION, STRENGTH DATA IS GIVEN FOR FAILURE OF THE PRODUCT OR FOR SUFFICIENT DEFORMATION TO MAKE THE PRODUCT INOPERABLE. NO SAFETY FACTOR HAS BEEN APPLIED. IT IS RECOMMENDED THAT THE USER REQUEST A PRODUCT SAMPLE FOR TESTING TO DETERMINE THE SUITABILITY OF THE PRODUCT FOR THE PURPOSE INTENDED AND USER'S PARTICULAR APPLICATION.

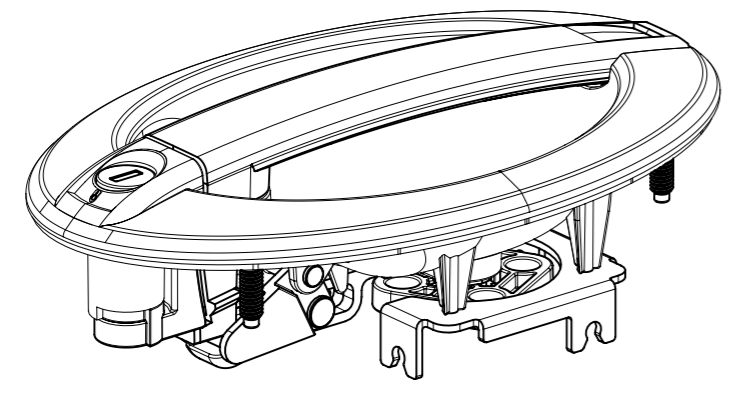

AC-11-3Y1-11: MULTIPOINT W/ CABLE BRACKET

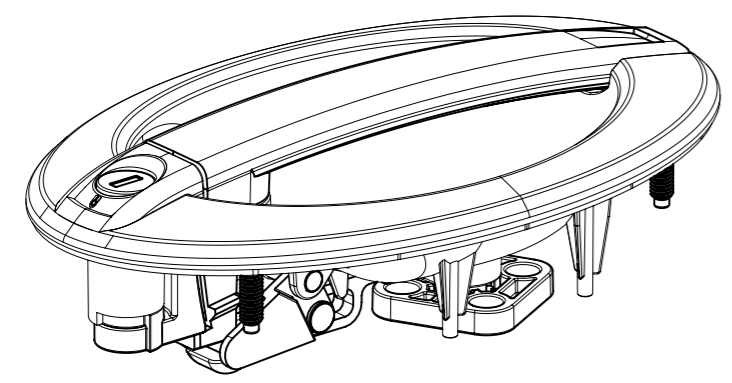

AC-11-2Y1-11: MULTIPOINT W/O CABLE BRACKET

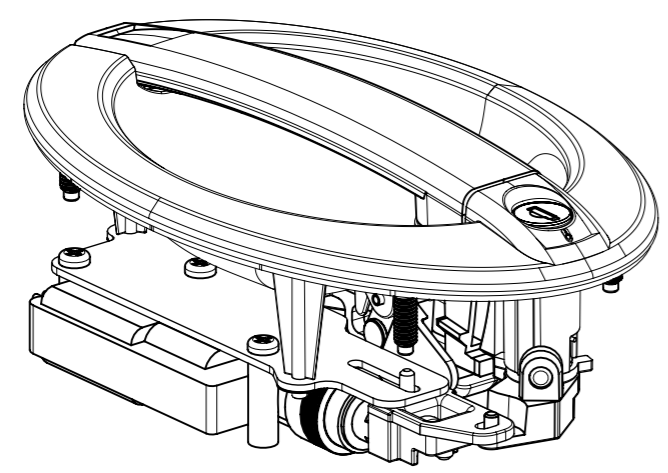

AC-11-EM-3Y1-11: MULTI-POINT W/ CABLE BRACKET & LOCK/UNLOCK ELECTRONIC ACTUATOR

|                 | AVERAGE ULTIMATE STRENGTH |          | INSTALLATION TORQUE | CYCLE LIFE |
|-----------------|---------------------------|----------|---------------------|------------|
|                 | LOCKED                    | UNLOCKED |                     |            |
| AC-11-3Y1-11    | 1855 N                    | 3110 N   | 7 N-m MAX           | 40,000     |
| AC-11-2Y1-11    | 1855 N                    | 3110 N   | 7 N-m MAX           |            |
| AC-11-EM-3Y1-11 | 1855 N                    | 3110 N   | 7 N-m MAX           | 40,000     |

1. ULTIMATE STRENGTH TESTS WERE PERFORMED WITH PART NUMBER AC-11-341-11.
2. CONSULT SOUTHCO FOR OTHER TECHNICAL DETAILS.

NOTE:  
SOUTHCO ACTUATOR USED IN A PASSENGER RESTRAINT SYSTEM MUST BE FULLY TESTED IN THE DOOR SYSTEM

|   |   |                    |                     |
|---|---|--------------------|---------------------|
| THIRD ANGLE PROJECTION  |   |                    |                     |
|   |   |                    |                     |
| TOLERANCES UNLESS OTHERWISE NOTED   | DESCRIPTION<br>CUPPER HANDLE ACTUATOR<br>FLUSH MOUNT - OVAL |                    |                     |
| ALL DIMENSIONS WITHOUT TOLERANCES ARE FOR REFERENCE ONLY.   | SIZE<br>A3  | SYSTEM<br>NX       | DWG NO.<br>TD-AC-11 |
| PROPRIETARY ITEM<br><small>EXCEPT FOR USES EXPRESSLY GRANTED IN WRITING, INFORMATION DISCLOSED HEREON IS CONFIDENTIAL AND ALL RIGHTS, PATENT AND OTHERWISE, ARE RESERVED BY SOUTHCO, INC.</small> | PER ASME Y14.5M-1994  | DRAWN BY<br>PK/AJT | DATE<br>20MAR2019   |
|   |   | SCALE<br>1:2       | SHEET<br>1 OF 1     |